

E-Designs Plans Inc.

A western Canadian company from Alberta that designs and ships home plans all across Canada, the US, and Overseas.

For more information about this plan contact the designer at: info@edesignsplans.ca.

Plan #: 2001103 Front Elevation

www.edesignsplans.ca

Call Us 1-855-675-1800



Rear Elevation



Bungalow with 1-Car Angled Garage
832 Sq. Ft. Main Floor

Plan #: 2001103

Width: 62'-0"
Depth: 32'-0"
Bedrooms: 1
Bathrooms: 2
Main Floor Laundry: Yes
Walk-in Pantry: Yes
Office/Den: No

Exterior Walls: 2x6 x 8 Ft. (Main Floor)
Foundation: Slab on 4' Concrete
(Other Foundations Available)
Special Ceilings: Vaulted Front to Back
Fireplace: No
Deck(s): Rear (Covered)
Veranda: Yes
Attached Garage: Yes (2-Car with 10'x8' Doors)
Finished Basement Plan: No

832 Sq. Ft. Bungalow. This would make a perfect cabin/cottage at the lake. Very simple and cost effective to build. This plan may be small, but it has everything you'll need. The kitchen/nook area is open to the living room. These rooms are nice and bright because of the double garden doors and windows in the living room. The bathroom is located off the kitchen and is accessible from the bedroom. The 3-piece bath also features a 60"x36" walk-in shower. The spacious front entry also leads to the attached garage. The laundry room has a closet, upper and lower cabinets, including a laundry sink. Also a 2-piece bath is in this room. The mechanical room is located in the garage for better accessibility. The patios in the front and rear are both covered.

PROTECTED BY COPYRIGHT LAWS.
PROPERTY OF **E-DESIGNS PLANS INC.**

E-Designs Plans Inc.

A western Canadian company from Alberta that designs and ships home plans all across Canada, the US, and Overseas.

For more information about this plan contact the designer at: info@edesignsplans.ca.

Plan 2001103

www.edesignsplans.ca

[Call Us 1-855-675-1800](tel:1-855-675-1800)

Main Floor

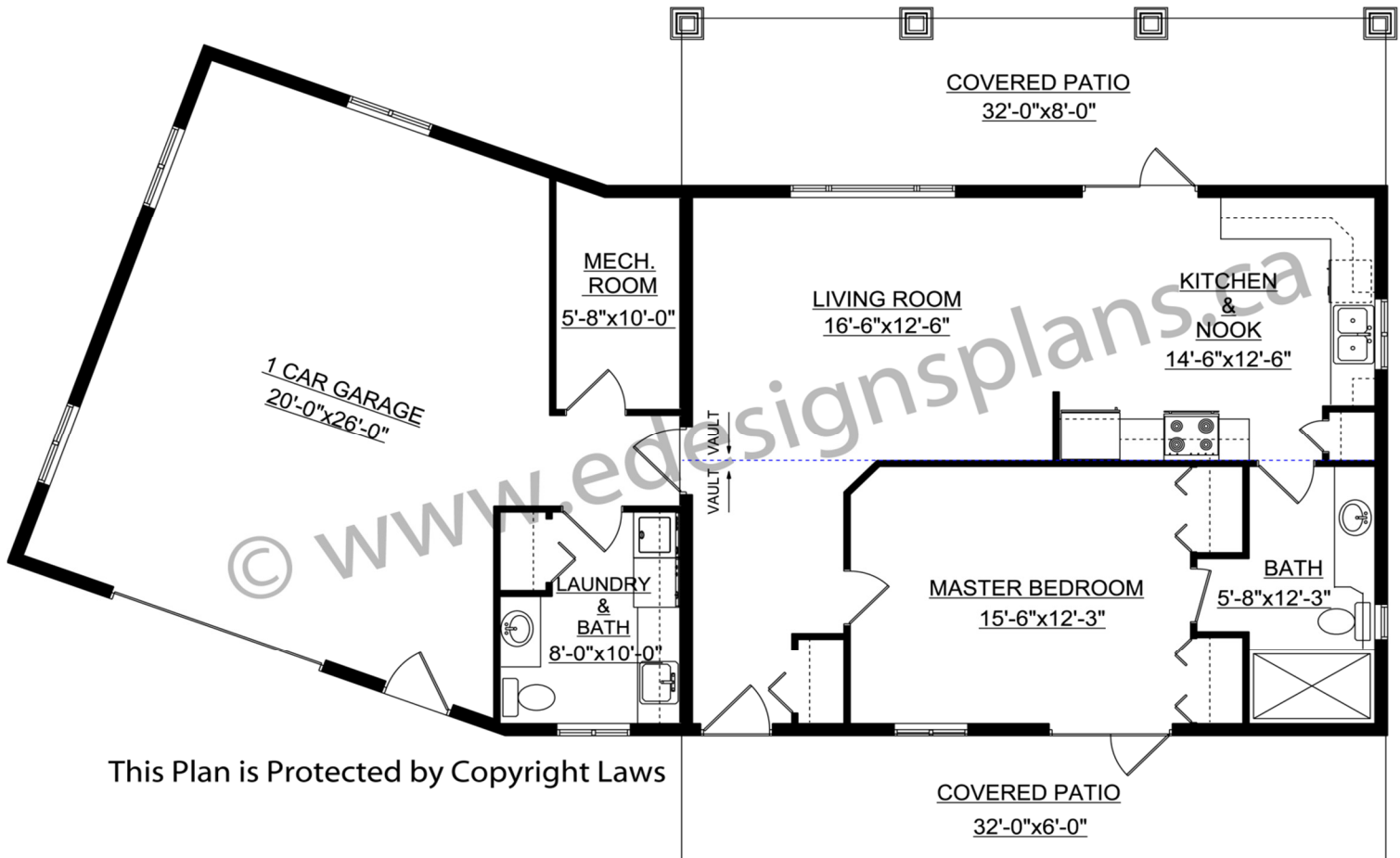

This Plan is Protected by Copyright Laws

PROTECTED BY COPYRIGHT LAWS.
PROPERTY OF **E-DESIGNS PLANS INC.**