

# E-Designs Plans Inc.

A western Canadian company from Alberta that designs and ships home plans all across Canada, the US, and Overseas.

For more information about this plan contact the designer at: [info@edesignsplans.ca](mailto:info@edesignsplans.ca).

**Plan #: 2011563 Front Elevation**

[www.edesignsplans.ca](http://www.edesignsplans.ca)

**Call Us 1-855-675-1800**



**Rear Elevation**



**Bungalow with Walkout Basement**

1987 Sq. Ft. Main Floor

Width: 82'-10"  
 Depth: 79'-7" (plus deck)  
 Bedrooms: 2  
 Bathrooms: 2  
 Main Floor Laundry: Yes  
 Walk-in Pantry: Yes  
 Office/Flex Room: Yes

**Plan #: 2011563**

Exterior Walls: 2x6 x 8 Ft. (Main Floor)  
 Foundation: 9' ICF (Insulated Concrete Form) (Other Foundations Available)  
 Special Ceilings: 4-Way Vault  
 Fireplace: Yes  
 Deck(s): Rear  
 Veranda: Yes (Covered)  
 Attached Garage: Yes (3-Car with 10'x8' Doors)  
 Finished Basement Plan: No

**1987 Sq. Ft. Bungalow with Walkout Basement:** Lots of room and extras in this beautiful home plan. The front veranda has a stone railing with craftsman style posts to match the rest of the exterior on the front. Wider corners and trim around the doors and windows really makes this house stand out. From the large front entry you soon see the openness of this floor plan. Off to the left is a "Flex" Room. Lots of possibilities here, like an office/den, spare room, etc. The "L" shaped kitchen has a corner pantry and a large angled working island. The dining room has a bayed area with lots of windows and a double garden door leading to the large rear deck. The great room has a gas fireplace in between two windows. This part of the house has a 4-way vaulted ceiling. An open stairwell takes you to the walkout basement. Down the hallway is the laundry room and access to an angled 3-car garage. Lots of extra storage space or room for a workshop in the angled section of the garage. Past the laundry room you have a nice-sized spare bedroom with a three-piece bath across the hallway. The master bedroom features a bayed out area with a double garden door leading out to the rear deck. Also a walk-in closet and a four-piece ensuite with a 6 foot soaker tub. The basement is undeveloped except for the mechanical room. The rear of the basement has two double garden doors and two large windows. The patio in the rear is covered by the deck above. Loads of possibilities to design the basement plan in the future. This plan can be built with or without a walkout basement.

PROTECTED BY COPYRIGHT LAWS.  
 PROPERTY OF **E-DESIGNS PLANS INC.**

# E-Designs Plans Inc.

A western Canadian company from Alberta that designs and ships home plans all across Canada, the US, and Overseas.

For more information about this plan contact the designer at: [info@edesignsplans.ca](mailto:info@edesignsplans.ca).

Plan 2011563

[www.edesignsplans.ca](http://www.edesignsplans.ca)

Call Us 1-855-675-1800

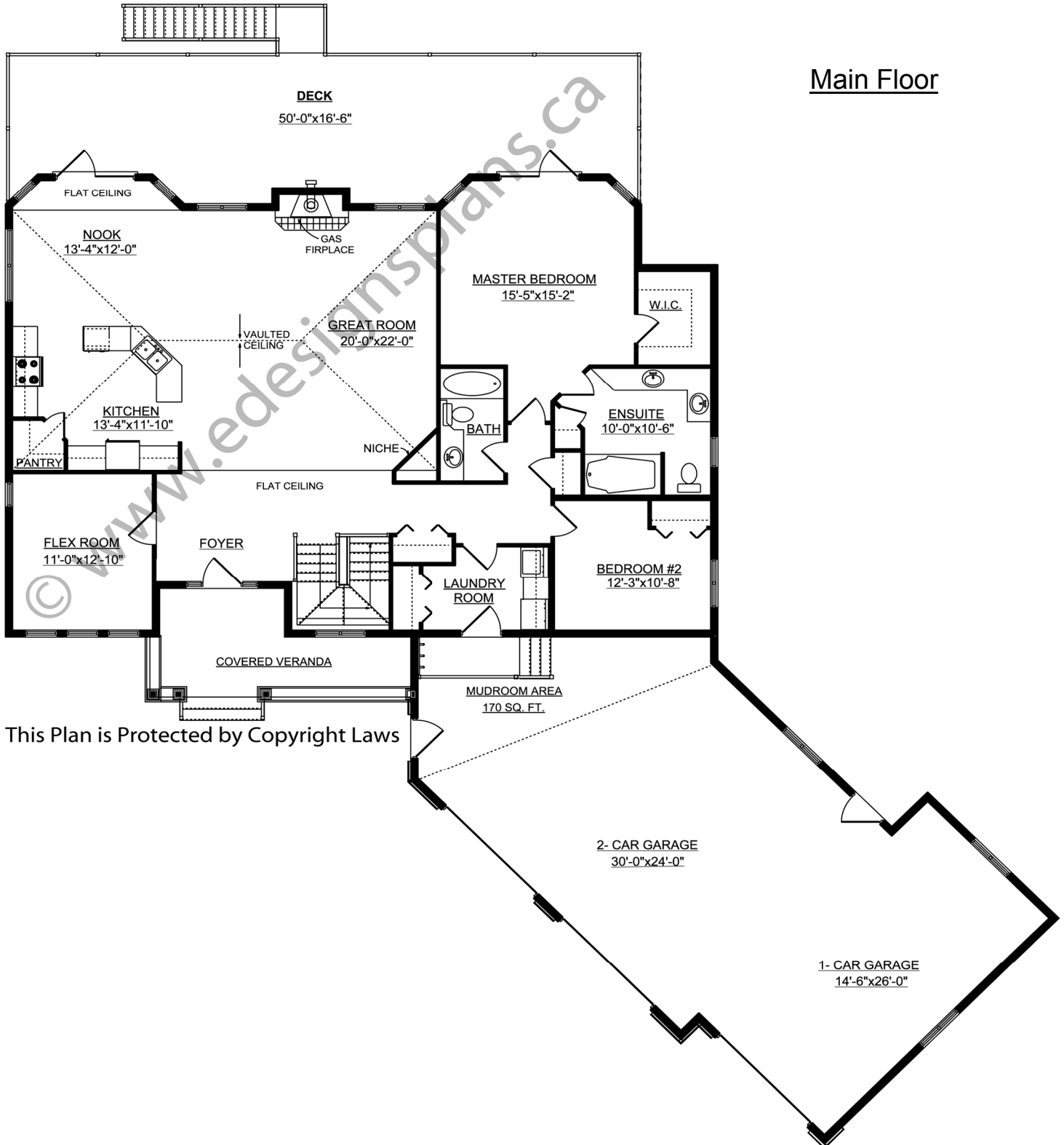

Main Floor

This Plan is Protected by Copyright Laws

PROTECTED BY COPYRIGHT LAWS.  
PROPERTY OF **E-DESIGNS PLANS INC.**