

E-Designs Plans Inc.

A western Canadian company from Alberta that designs and ships home plans all across Canada, the US, and Overseas.

For more information about this plan contact the designer at: info@edesignsplans.ca.

Plan #: 2012629 Front Elevation

www.edesignsplans.ca

Call Us 1-855-675-1800



Rear Elevation



Bungalow with 2-Car Garage 1617 Sq. Ft. Main Floor

Width: 59'-0"
Depth: 56'-0"
Bedrooms: 3
Bathrooms: 2
Main Floor Laundry: Yes
Walk-in Pantry: Yes
Office/Den: No

Plan #: 2012629

Exterior Walls: 2x6 x 8 Ft. (Main Floor)
Foundation: 9' ICF (Insulated Concrete Form)
(Other Foundations Available)
Special Ceilings: None
Fireplace: No
Deck(s): Rear (Covered)
Veranda: No
Attached Garage: Yes (2-Car with 10'x8' Doors)
Finished Basement Plan: No

Bungalow with 2-Car Garage. This plan is very practical. Some of the nice features of this particular plan are the bedrooms and laundry are all on the same floor as the living space. A nice 3-bedroom home with a big sunny kitchen/nook area and a huge walk-in pantry. The nook has double garden doors that lead to a covered deck in the rear. The laundry room is conveniently located right inside the garage so dirty clothes can be dropped right into the washer on the way in. The nook and master bedroom are candelivered for additional space. A 3-piece ensuite and walk-in closet compliment the master bedroom. Two overhead 10' x 8' doors in the garage and check out the rear garage with a small overhead door, which is perfect for your ATV, riding lawnmower, or workshop. Overall, a great use of space!

PROTECTED BY COPYRIGHT LAWS.
PROPERTY OF **E-DESIGNS PLANS INC.**

E-Designs Plans Inc.

A western Canadian company from Alberta that designs and ships home plans all across Canada, the US, and Overseas.

For more information about this plan contact the designer at: info@edesignsplans.ca.

Plan 2012629

www.edesignsplans.ca

[Call Us 1-855-675-1800](tel:1-855-675-1800)

Main Floor

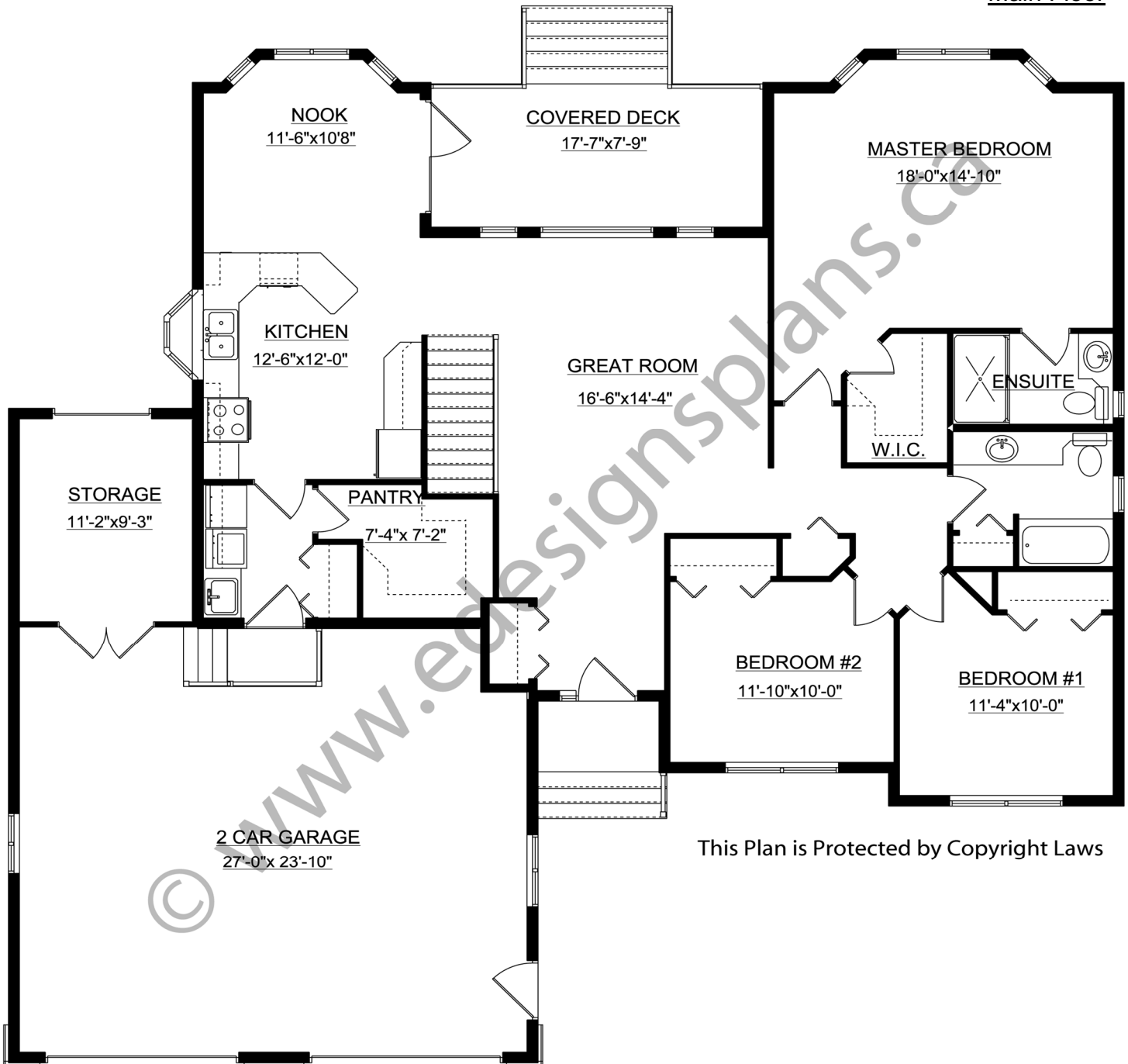

This Plan is Protected by Copyright Laws

PROTECTED BY COPYRIGHT LAWS.
PROPERTY OF **E-DESIGNS PLANS INC.**