

# E-Designs Plans Inc.

A western Canadian company from Alberta that designs and ships home plans all across Canada, the US, and Overseas.

For more information about this plan contact the designer at: [info@edesignsplans.ca](mailto:info@edesignsplans.ca).

**Plan #: 2013715 Front Elevation**

[www.edesignsplans.ca](http://www.edesignsplans.ca)

**Call Us 1-855-675-1800**



**Rear Elevation**



**Bungalow with Walkout & Angled Garage**

2401 Sq. Ft. Main Floor

Width: 112'-10"  
 Depth: 74'-9" (plus deck)  
 Bedrooms: 5  
 Bathrooms: 3 & a Half Bath  
 Main Floor Laundry: Yes  
 Walk-in Pantry: Yes  
 Office/Den: Yes

**Plan #: 2013715**

Exterior Walls: 2x6 x 9 Ft. (Main Floor)  
 Foundation: 9' ICF (Insulated Concrete Form) (Other Foundations Available)  
 Special Ceilings: Vaulted Great Room  
 Fireplace: Yes  
 Deck(s): Rear (Partially Covered)  
 Veranda: Yes  
 Attached Garage: Yes (3-Car 10'x10' & 10'x8' Doors)  
 Finished Basement Plan: Yes

**Bungalow with Walkout & 3-Car Angled Garage.** A plan that would be great for the farm or an acreage. It has a great country-style look with its 3-car garage, craftsman style post, brick trim, and covered veranda. From the front foyer you enter into the great room which has a vaulted ceiling. A corner gas fireplace is warming on those cooler nights. The dining room is open to the L-shaped kitchen. The kitchen has a huge walk-in pantry and an island with lunch bar. Exit double garden doors from the dining room out to a partially covered rear deck. An office is located at the front of the house. An arched entry to the hallway leads to the large master bedroom with a 4-piece ensuite and a huge walk-in closet. An additional bedroom is located on this floor as well as a 3-piece bathroom. Main floor laundry with a sink and counter is located in the corner of the design. Down the stairs leads you into a huge rec room, also with a gas fireplace, and a large game/media area. Exit the double doors from the rec room to the walkout patio area. Three more bedrooms are on this level, two with their own walk-in closets. A 4-piece bathroom is on this level as well as an additional laundry room. A hobby or exercise room is built into this design, plus a small storage room. The mechanical room is in the basement as well. A half bath is located just inside the entrance from the garage on the main floor for added convenience. You will love this large new garage with two 10'x8' overhead doors and one 10'x10' overhead door, plus room for a workshop area.

PROTECTED BY COPYRIGHT LAWS.  
 PROPERTY OF **E-DESIGNS PLANS INC.**

# E-Designs Plans Inc.

A western Canadian company from Alberta that designs and ships home plans all across Canada, the US, and Overseas.

For more information about this plan contact the designer at: [info@edesignsplans.ca](mailto:info@edesignsplans.ca).

Plan 2013715

[www.edesignsplans.ca](http://www.edesignsplans.ca)

Call Us 1-855-675-1800

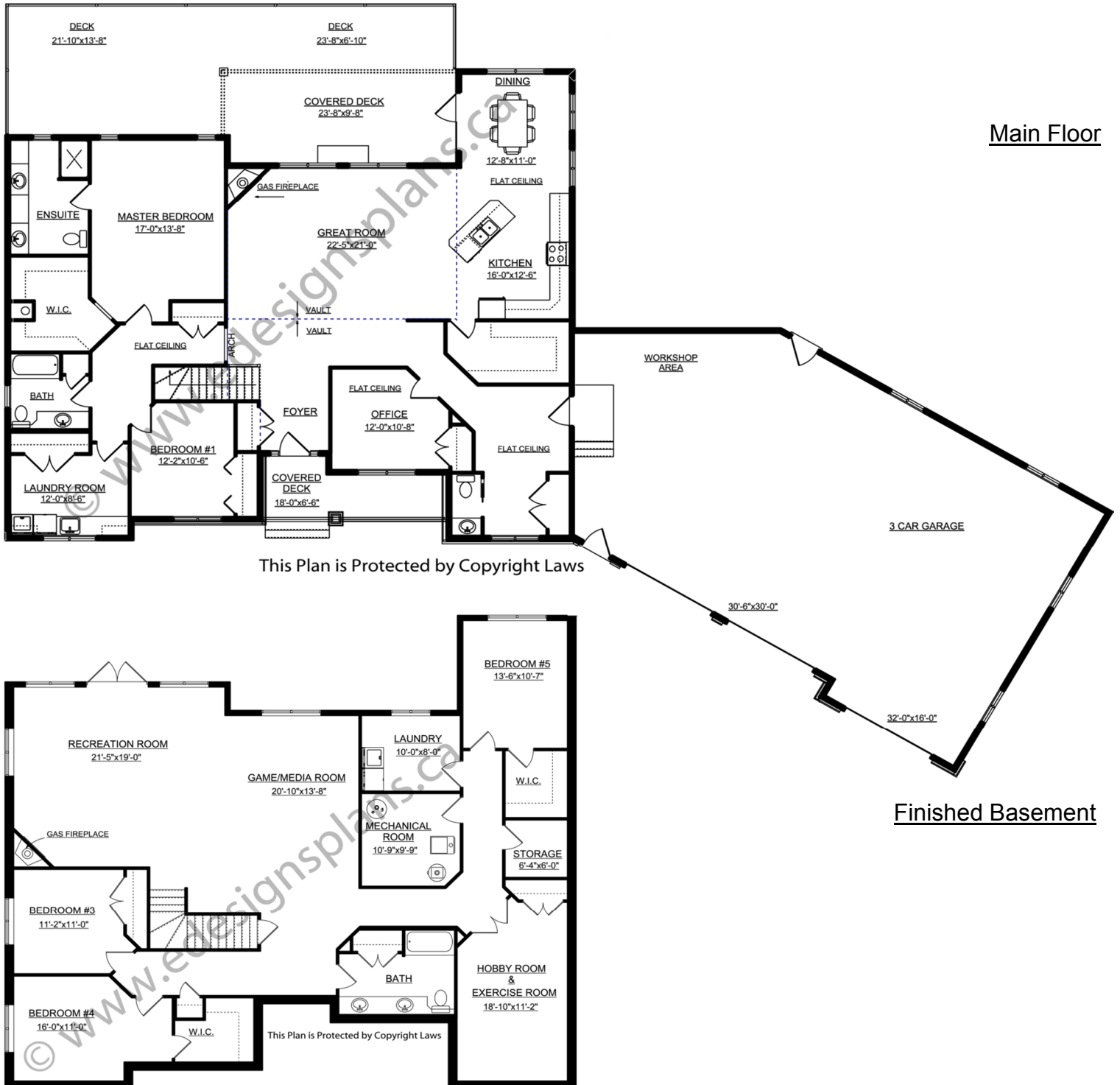

PROTECTED BY COPYRIGHT LAWS.  
PROPERTY OF **E-DESIGNS PLANS INC.**