

E-Designs Plans Inc.

A western Canadian company from Alberta that designs and ships home plans all across Canada, the US, and Overseas.

For more information about this plan contact the designer at: info@edesignsplans.ca.

Plan #: 2013756 Front Elevation

www.edesignsplans.ca

[Call Us 1-855-675-1800](tel:1-855-675-1800)



Rear Elevation



Bungalow with Walkout & Angled Garage
1697 Sq. Ft. Main Floor

Plan #: 2013756

Width: 67'-9"
Depth: 84'-5"
Bedrooms: 3
Bathrooms: 2 & a Half Bath
Main Floor Laundry: Yes
Walk-in Pantry: Yes
Office/Den: Yes
Finished Basement Plan: Yes

Exterior Walls: 2x6 x 9 Ft. (Main Floor)
Foundation: 9' ICF (Insulated Concrete Form) (Other Foundations Available)
Special Ceilings: 12' Ceiling in Great Room (Open to 2nd Floor)
Fireplace: Yes
Deck(s): Rear (Covered)
Veranda: Yes
Attached Garage: Yes (2-Car with 10'x8' Doors)

Bungalow with Walkout & 2-Car Angled Garage. A great plan for a farmhouse or acreage with its country style look. Enjoy the front covered veranda, craftsman style posts, and thin slate stone trim. Enter the foyer area with 9' ceiling. An office/den is off to the right, just inside the door. From the foyer you enter the great room, which has a 12' ceiling and is open to the second floor. It has a corner fireplace with built-in entertainment unit. The great room leads into the kitchen/dining room area, which has a 9' ceiling. The kitchen has a large walk-through pantry which also leads into the main floor laundry room with an additional sink. You can access the laundry room area from the garage entrance as well. A huge island with lunch counter is in the kitchen. Exit from the dining room to the rear deck, which has an open area, but both ends are covered. You can also access the deck from the master bedroom. There is a huge 5-piece ensuite and huge walk-in closet as part of the master bedroom. The toilet is in a separate space for added convenience. An additional half bath is on this level. Down the stairs leads you to a huge open area which has a recreation room, games area, and full wet bar. Exit from the games room area to access the walkout patio. A fireplace with a built-in entertainment centre is in the corner of the rec room. This level has a 4-piece bathroom and two additional bedrooms, plus a craft or exercise room, and the mechanical room as well. The attached angled garage has two 10'x8' overhead doors and a workshop area.

PROTECTED BY COPYRIGHT LAWS.
PROPERTY OF **E-DESIGNS PLANS INC.**

E-Designs Plans Inc.

A western Canadian company from Alberta that designs and ships home plans all across Canada, the US, and Overseas.

For more information about this plan contact the designer at: info@edesignsplans.ca.

Plan 2013756

www.edesignsplans.ca

[Call Us 1-855-675-1800](tel:1-855-675-1800)

Main Floor

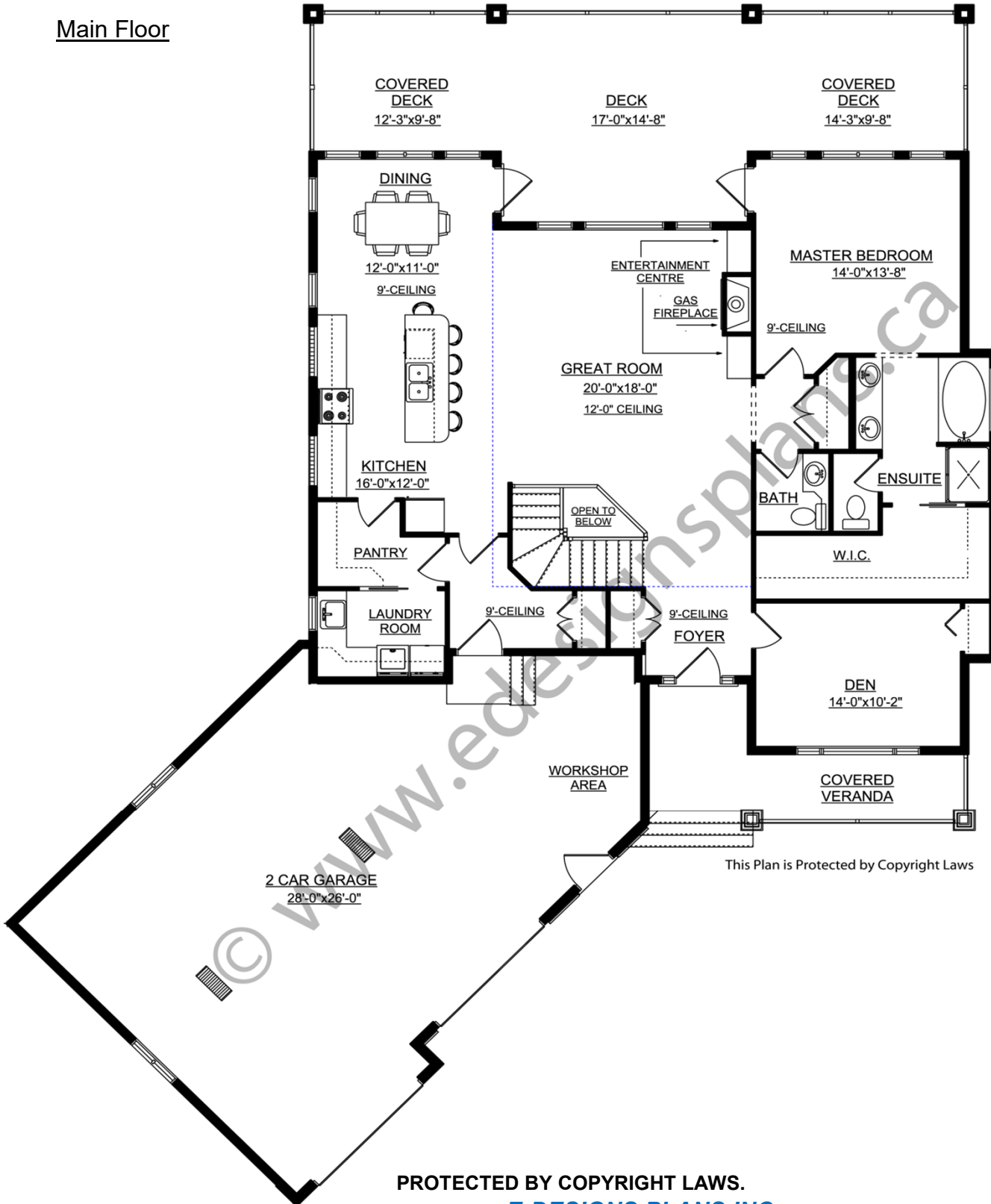

PROTECTED BY COPYRIGHT LAWS.
PROPERTY OF **E-DESIGNS PLANS INC.**

E-Designs Plans Inc.

A western Canadian company from Alberta that designs and ships home plans all across Canada, the US, and Overseas.

For more information about this plan contact the designer at: info@edesignsplans.ca.

Plan 2013756

www.edesignsplans.ca

[Call Us 1-855-675-1800](tel:1-855-675-1800)

Finished Basement

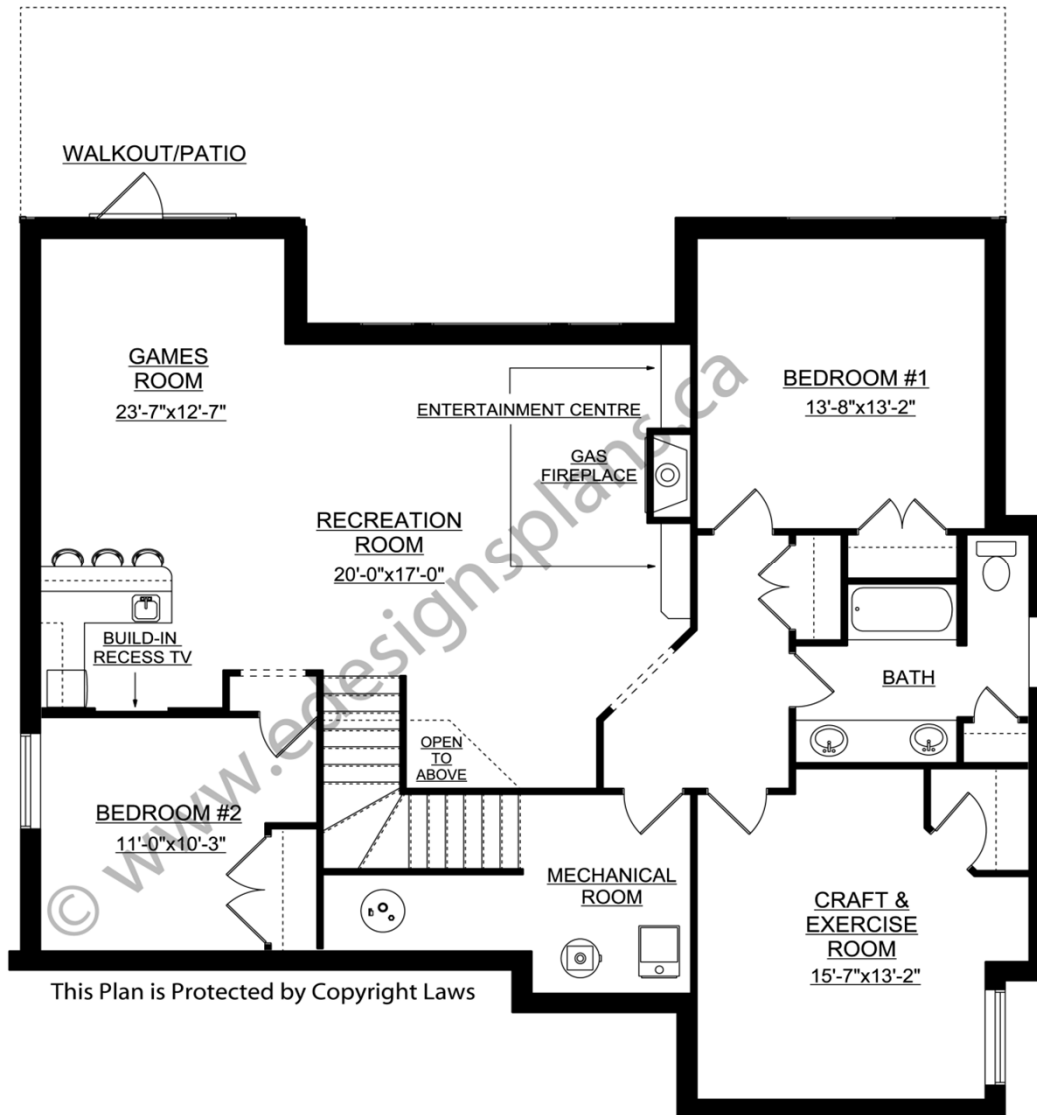

This Plan is Protected by Copyright Laws

PROTECTED BY COPYRIGHT LAWS.
PROPERTY OF **E-DESIGNS PLANS INC.**