

E-Designs *Plans Inc.*

A western Canadian company from Alberta that designs and ships home plans all across Canada, the US, and Overseas.

For more information about this plan contact the designer at: info@edesignsplans.ca.

Plan #: 2014784 Front Elevation

www.edesignsplans.ca

[Call Us 1-855-675-1800](tel:1-855-675-1800)



Bungalow Plan

1690 Sq. Ft. Main Floor

Width: 60'-0"
Depth: 33'-0"
Bedrooms: 2
Bathrooms: 2
Main Floor Laundry: Yes
Walk-in Pantry: Yes
Flex Room/Office: Yes

Plan #: 2014784

Exterior Walls: 2x6 x 8 Ft. (Main Floor)
Foundation: 4' ICF (Insulated Concrete Form)
(Other Foundations Available)
Special Ceilings: None
Fireplace: Yes (Wood Stove)
Deck(s): Front & Side (Both Covered)
Veranda: No
Attached Garage: No
Finished Basement Plan: No

1690 Sq. Ft. Bungalow Plan. This Bungalow Plan would be great in town, in the country, or at the lake. All rooms are a nice size and the design is simple to build. Enter from the covered deck into the front entry with laundry area and closet. Also just inside is a large walk-in pantry just off the kitchen. The U-shaped kitchen has plenty of cabinet and counter space. The dining room has double garden doors leading onto the front covered deck. The living room has a corner wood stove for those cooler evenings. The master suite has his and hers closets and a 3-piece ensuite. There is another bedroom on this level, along with a flex room and another 3-piece bathroom. The utility room is behind the front entry and has the access to the crawl space underneath.

E-Designs Plans Inc.

A western Canadian company from Alberta that designs and ships home plans all across Canada, the US, and Overseas.

For more information about this plan contact the designer at: info@edesignsplans.ca.

Plan 2014784

www.edesignsplans.ca

Call Us 1-855-675-1800

Main Floor

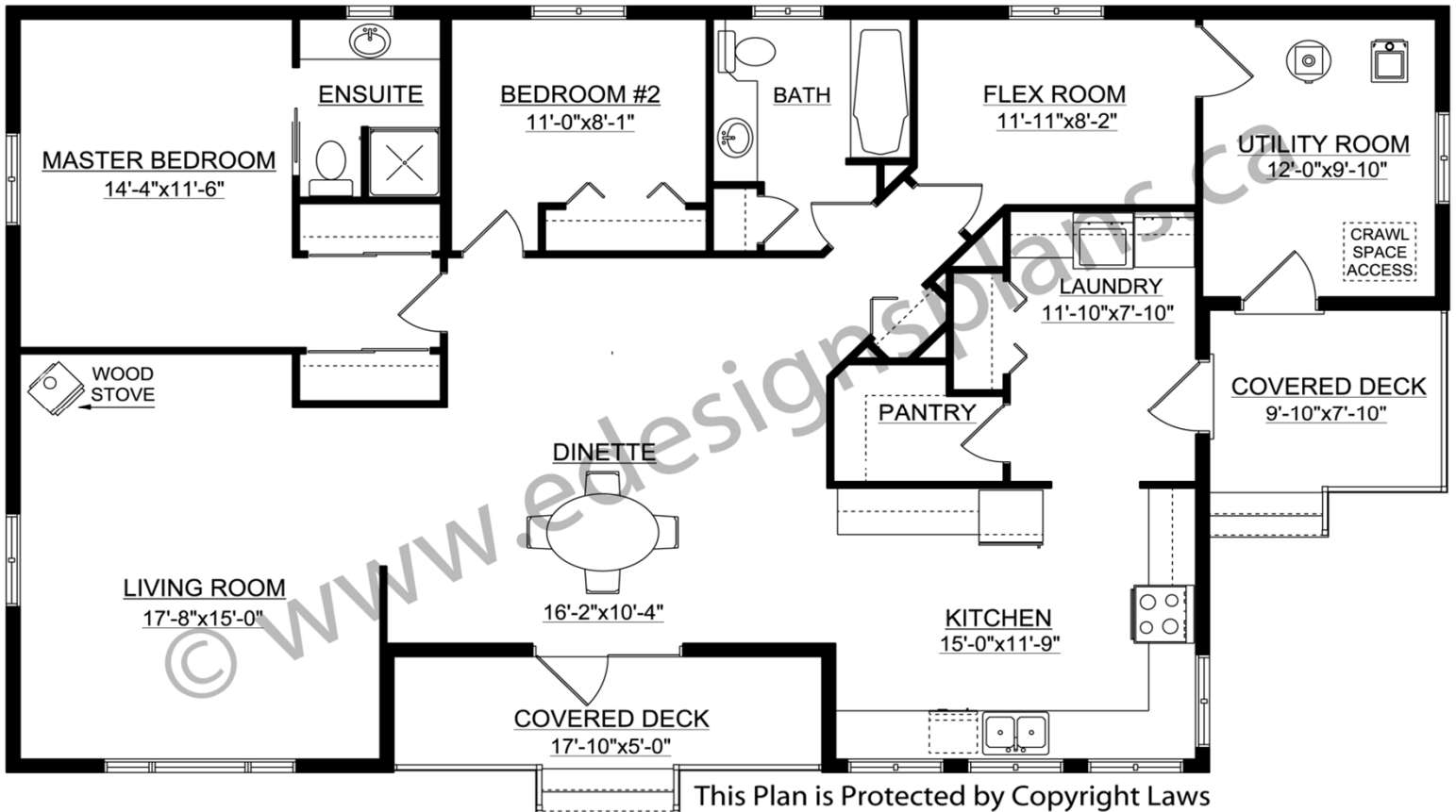

This Plan is Protected by Copyright Laws

PROTECTED BY COPYRIGHT LAWS.
PROPERTY OF **E-DESIGNS PLANS INC.**