

E-Designs Plans Inc.

A western Canadian company from Alberta that designs and ships home plans all across Canada, the US, and Overseas.

For more information about this plan contact the designer at: info@edesignsplans.ca.

Plan #: 2014836 Front Elevation

www.edesignsplans.ca

Call Us 1-855-675-1800



Rear Elevation



Bungalow with Walkout & 3-Car Garage

2249 Sq. Ft. Main Floor

Width: 84'-4"
 Depth: 79'-8" (plus deck)
 Bedrooms: 3
 Bathrooms: 2
 Main Floor Laundry: Yes
 Walk-in Pantry: Yes
 Flex Room/Office: Yes

Plan #: 2014836

Exterior Walls: 2x6 x 8 Ft. (Main Floor)
 Foundation: 9' ICF (Insulated Concrete Form) (Other Foundations Available)
 Special Ceilings: 4-Way Vault
 Fireplace: Yes
 Deck(s): Rear
 Veranda: Yes (Covered)
 Attached Garage: Yes (3-Car with 10'x8' Doors)
 Finished Basement Plan: No

Bungalow with Walkout & 3-Car Angled Garage. Plenty of space in this 2249 square foot bungalow. A great looking plan for a farm or acreage with its cottage roof, covered front veranda, posts, and stone trim. There is a spectacular view off the large rear deck, which is open to enjoy all the sunshine of the day. Or spend time under the deck on the walkout patio in the shade. Whatever the weather, you'll be able to enjoy the outdoors with this plan. Immediately off the foyer is a flex room. The great room, kitchen and nook are open concept with a 4-way vault above them all. There is a gas fireplace in the great room to enjoy in winter. The kitchen has a huge angled island and corner pantry. Double garden doors from the nook or master bedroom provide access to the rear deck. There are three bedrooms, a 3-piece bath, and main floor laundry all on this level. The master suite has a huge walk-in closet and 4-piece ensuite of its own. The basement is undeveloped but is a walkout so plenty of natural lighting. Double your living space here. The 3-car angled garage has plenty of space for a work area too.

PROTECTED BY COPYRIGHT LAWS.
 PROPERTY OF **E-DESIGNS PLANS INC.**

E-Designs Plans Inc.

A western Canadian company from Alberta that designs and ships home plans all across Canada, the US, and Overseas.

For more information about this plan contact the designer at: info@edesignsplans.ca.

Plan 2014836

www.edesignsplans.ca

Call Us 1-855-675-1800

Main Floor

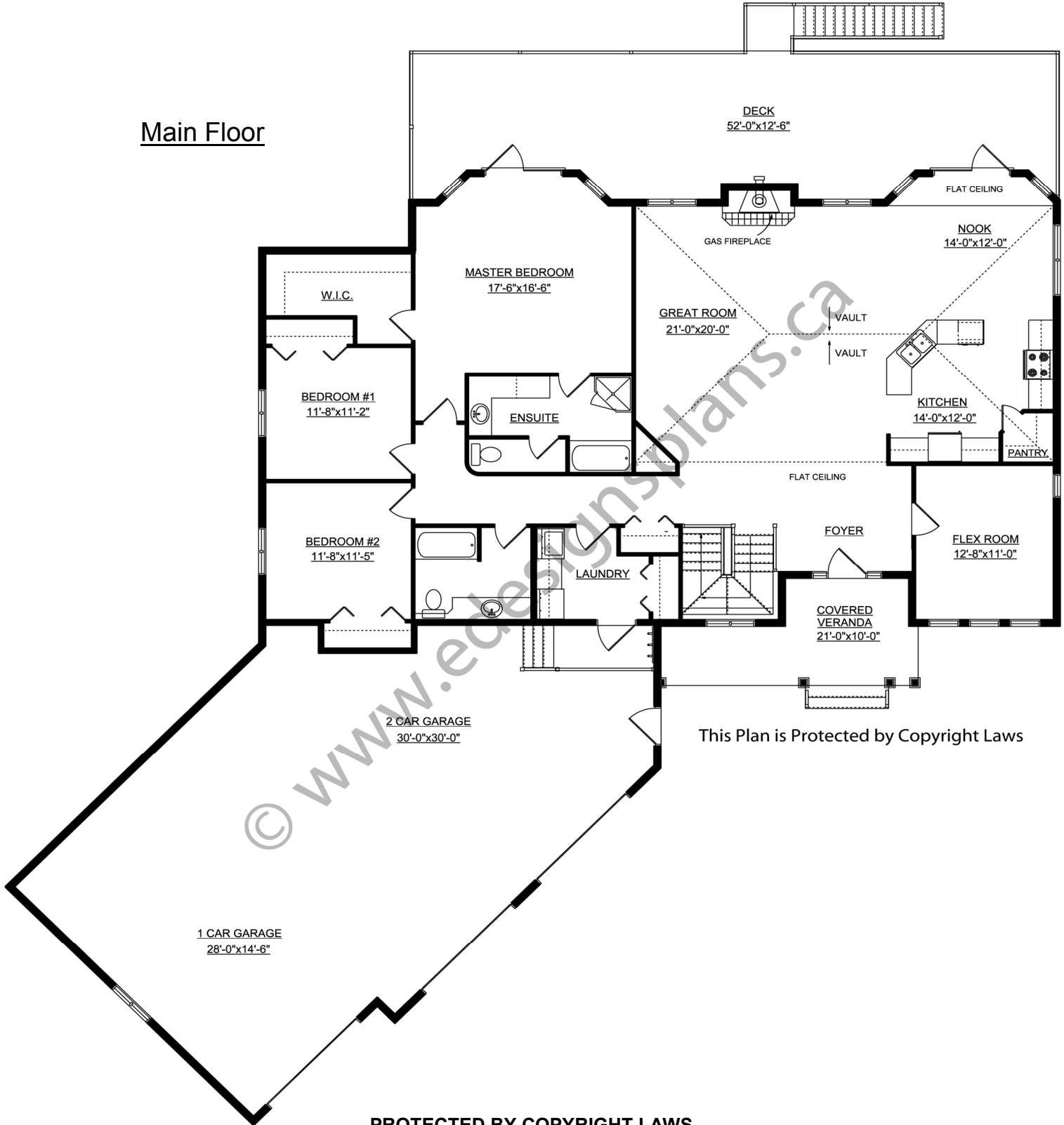

This Plan is Protected by Copyright Laws

PROTECTED BY COPYRIGHT LAWS.
PROPERTY OF **E-DESIGNS PLANS INC.**