

E-Designs Plans Inc.

A western Canadian company from Alberta that designs and ships home plans all across Canada, the US, and Overseas.

For more information about this plan contact the designer at: info@edesignsplans.ca.

Plan #: 2017129 Front Elevation

www.edesignsplans.ca

[Call Us 1-855-675-1800](tel:1-855-675-1800)



Rear Elevation



Bungalow with 3-Car Garage

1599 Sq. Ft. Main Floor

Width: 94'-0"
 Depth: 36'-6" plus Deck
 Bedrooms: 3
 Bathrooms: 2 & a Half Bath
 Main Floor Laundry: Yes
 Walk-in Pantry: Yes
 Office/Den: No

Plan #: 2017129

Exterior Walls: 2x6 x 8 Ft. (Main Floor)
 Foundation: 9' Concrete Wall
 (Other Foundations Available)
 Special Ceilings: Vaulted Kitchen, Dining & Living Rm
 Fireplace: No
 Deck(s): Rear
 Veranda: Yes (Covered)
 Attached Garage: Yes (3-Car with 10'x8' Doors)
 Finished Basement Plan: No

Ranch Style Bungalow with 3-Car Attached Garage. This bungalow, with its front covered veranda, has that ranch-style look. The triple car attached garage is plenty big for lots of vehicles and a workshop area. Enter from the front covered veranda or from the attached garage. There is laundry and a half bath right inside the garage entrance. The kitchen, dining room, and great room are all open concept with vaulted ceilings which makes the area appear even larger. There are three bedrooms on this floor with the master having its own walk-in closet and 3-piece ensuite. The other two bedrooms share a 3-piece bath. There is a deck off the rear through double garden doors. Downstairs, nothing is developed except for the mechanical room, so you can design it the way you wish.

E-Designs Plans Inc.

A western Canadian company from Alberta that designs and ships home plans all across Canada, the US, and Overseas.

For more information about this plan contact the designer at: info@edesignsplans.ca.

Plan 2017129

www.edesignsplans.ca

[Call Us 1-855-675-1800](tel:1-855-675-1800)

Main Floor

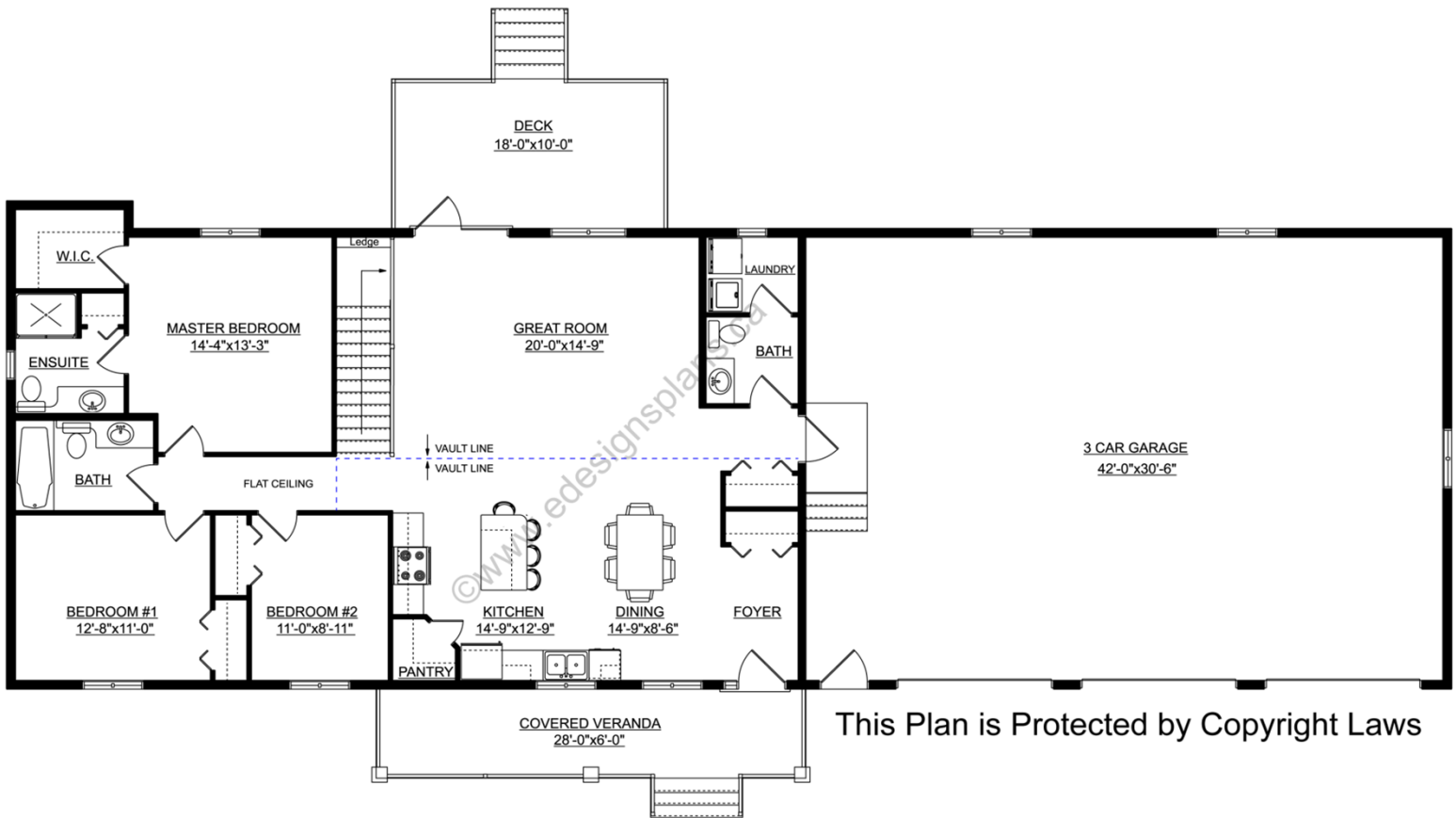

This Plan is Protected by Copyright Laws