

E-Designs Plans Inc.

A western Canadian company from Alberta that designs and ships home plans all across Canada, the US, and Overseas.

For more information about this plan contact the designer at: info@edesignsplans.ca.

Plan #: 2017137 Front Elevation

www.edesignsplans.ca

[Call Us 1-855-675-1800](tel:1-855-675-1800)



Rear Elevation

Bungalow Style Cabin with Walkout
1296 Sq. Ft. Main Floor

Width: 40'-0" plus Deck
Depth: 42'-0"
Bedrooms: 4
Bathrooms: 3
Main Floor Laundry: No
Walk-in Pantry: No
Office/Den: No

Plan #: 2017137

Exterior Walls: 2x6 x 8 Ft. (Main Floor)
Foundation: 8' ICF (Insulated Concrete Form) (Other Foundations Available)
Special Ceilings: Vaulted Kitchen, Dining & Living Rm
Fireplace: No
Deck(s): Front (Covered)
Veranda: No
Attached Garage: No
Finished Basement Plan: Yes

Bungalow Style Cabin Plan with Walkout. A great bungalow cabin plan with a walkout basement. With 1296 square feet on both floors, there is lots of living space in this design. The kitchen, dining room and living room are vaulted. There is a side entrance with a deck running the full length of the side right around to the front partially covered deck, which is also vaulted. Double garden doors lead from the dining room to the front deck as well. Lots of windows in the front gives you a great view from any room. The hallway coming in from the side entrance is extra wide so plenty of room for storage or coat hangers. There are two bedrooms in the rear, a 3-piece bath, and the master has its own 3-piece ensuite, plus wall-to-wall closets. Downstairs are two more bedrooms, a 3-piece bath, the mechanical room, and a large family room. Lots of windows down here as well as double doors leading to the outside patio, giving you a nice bright daylight basement.

E-Designs Plans Inc.

A western Canadian company from Alberta that designs and ships home plans all across Canada, the US, and Overseas.

For more information about this plan contact the designer at: info@edesignsplans.ca.

Plan 2017137

www.edesignsplans.ca

[Call Us 1-855-675-1800](tel:1-855-675-1800)

Main Floor

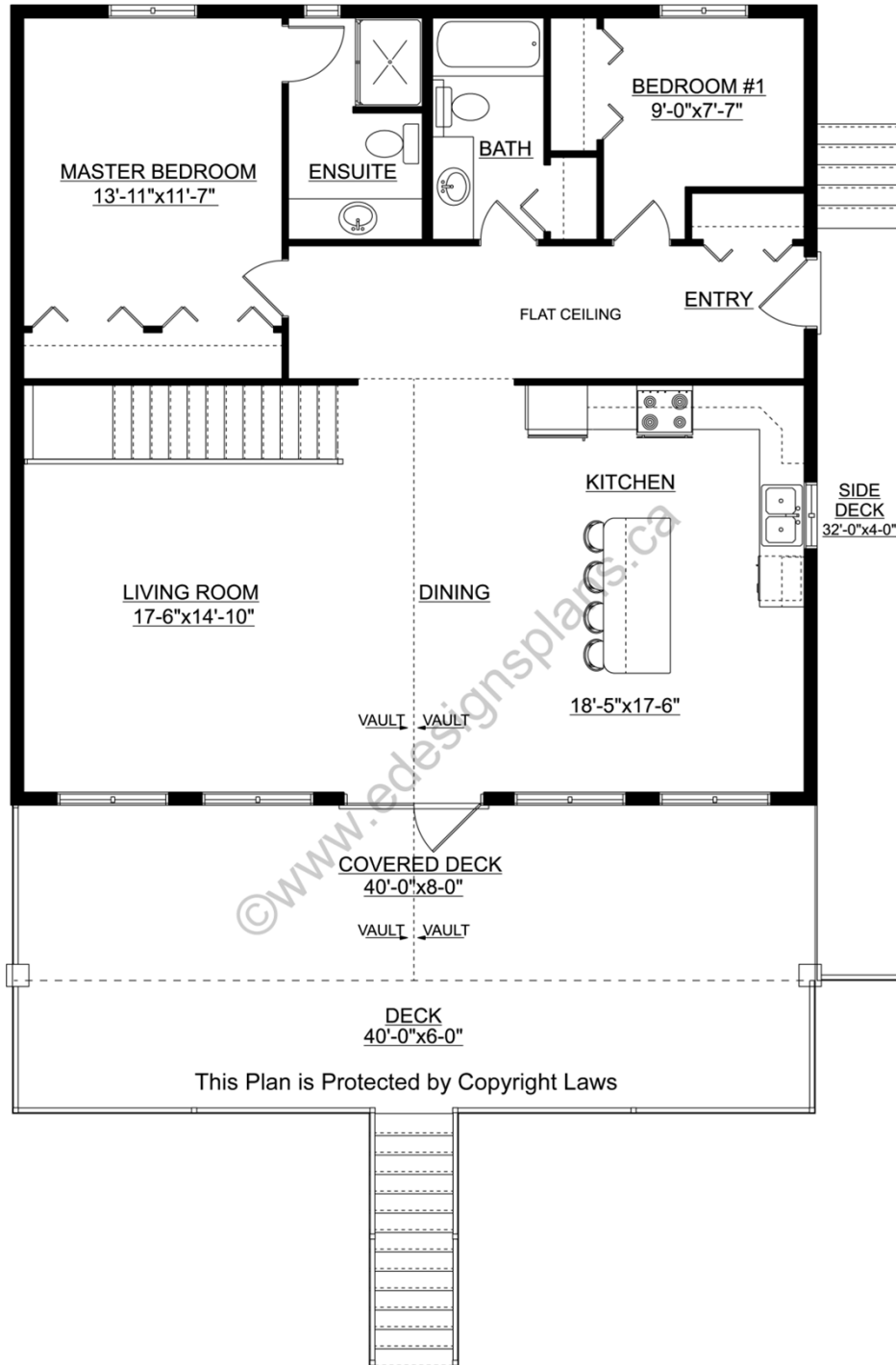

This Plan is Protected by Copyright Laws

E-Designs Plans Inc.

A western Canadian company from Alberta that designs and ships home plans all across Canada, the US, and Overseas.

For more information about this plan contact the designer at: info@edesignsplans.ca.

Plan 2017137

www.edesignsplans.ca

[Call Us 1-855-675-1800](tel:1-855-675-1800)

Basement

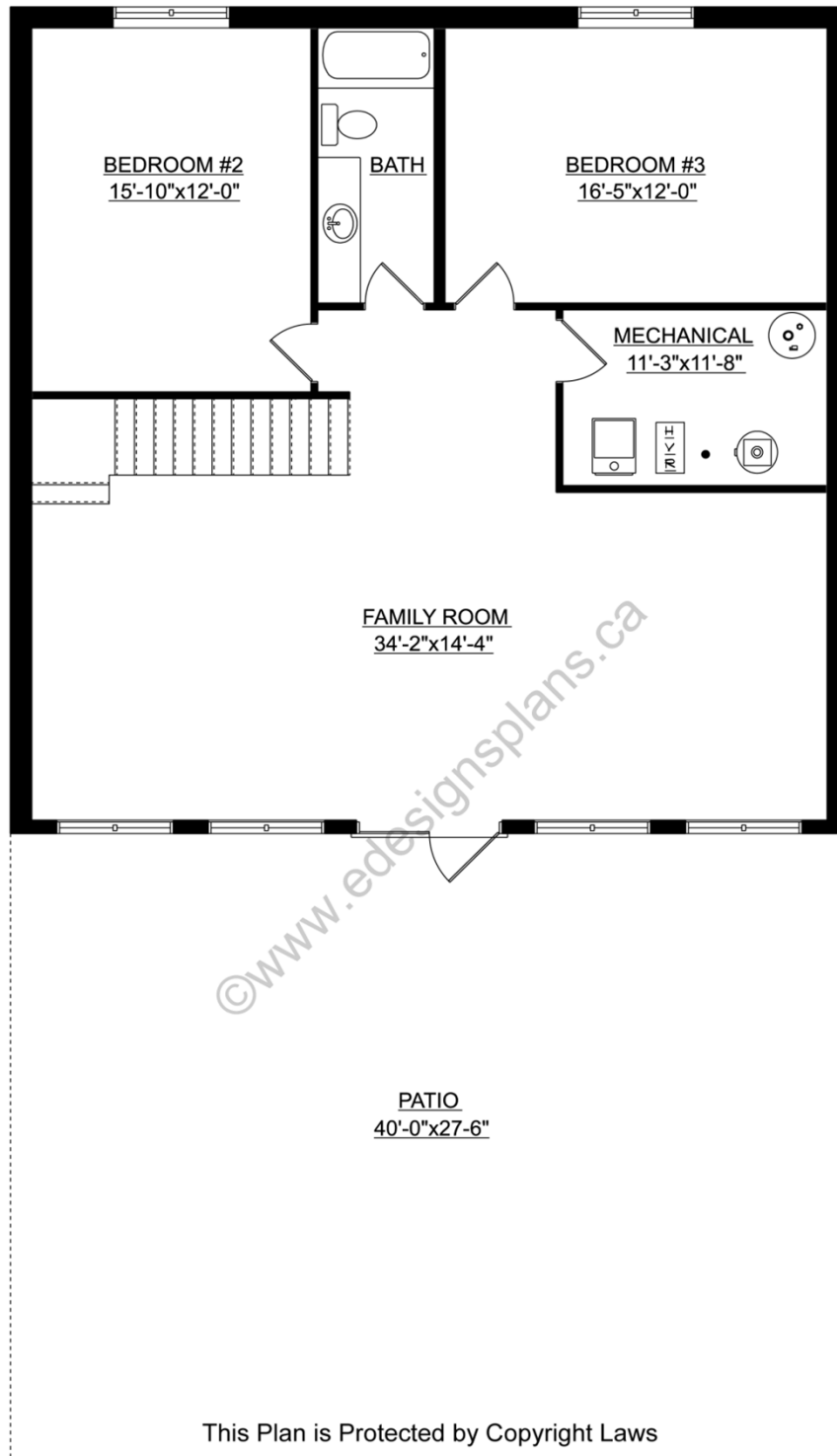

This Plan is Protected by Copyright Laws

PROTECTED BY COPYRIGHT LAWS.
PROPERTY OF **E-DESIGNS PLANS INC.**