

E-Designs Plans Inc.

A western Canadian company from Alberta that designs and ships home plans all across Canada, the US, and Overseas.

For more information about this plan contact the designer at: info@edesignsplans.ca.

Plan #: 2016986 Front Elevation

www.edesignsplans.ca

Call Us 1-855-675-1800



Rear Elevation



2-Storey Plan - Detached Garage

760 Sq. Ft. Main Floor

787 Sq. Ft. Second Floor

1547 Sq. Ft. Total Living Area

Width: 20'-0"
 Depth: 46'-0" plus Deck
 Bedrooms: 3
 Bathrooms: 2 & a Half Bath
 Main Floor Laundry: Yes
 Walk-in Pantry: Yes
 Office/Den: No

Plan #: 2016986

Exterior Walls: 2x6 x 8 Ft. (Main Floor)
 2x6 x 8 Ft. (Second Floor)
 Foundation: 9' Concrete Wall
 (Other Foundations Available)
 Special Ceilings: None
 Fireplace: No
 Deck(s): Rear
 Veranda: Yes (Covered)
 Attached Garage: No
 Finished Basement Plan: Yes (with 680 Sq. Ft. Suite)

2-Storey Plan with Basement Suite. Being only 20' wide, this 2-Storey is perfect for a narrow or infill lot. It would also work well as a rental with a separate entrance into the basement suite. The front has a covered deck the full width of the house. The living room overlooks the front yard. The kitchen and dining room are open to each other and are at the rear of the house. A garden door leads from the dining room to the rear deck. The kitchen has a walk-in pantry. Laundry is accommodated on this level. Upstairs are 3 bedrooms. The master bedroom is large and has its own walk-in closet and ensuite. Downstairs is a complete 680 sq. ft. rental suite which has its own separate entrance from the side of the house. It has a kitchenette, living room, bedroom, bathroom, storage, and its own stackable washer and dryer. The mechanical room for all 3 levels is in the basement.

E-Designs Plans Inc.

A western Canadian company from Alberta that designs and ships home plans all across Canada, the US, and Overseas.

For more information about this plan contact the designer at: info@edesignsplans.ca.

Plan 2016986

www.edesignsplans.ca

[Call Us 1-855-675-1800](tel:1-855-675-1800)

Main Floor

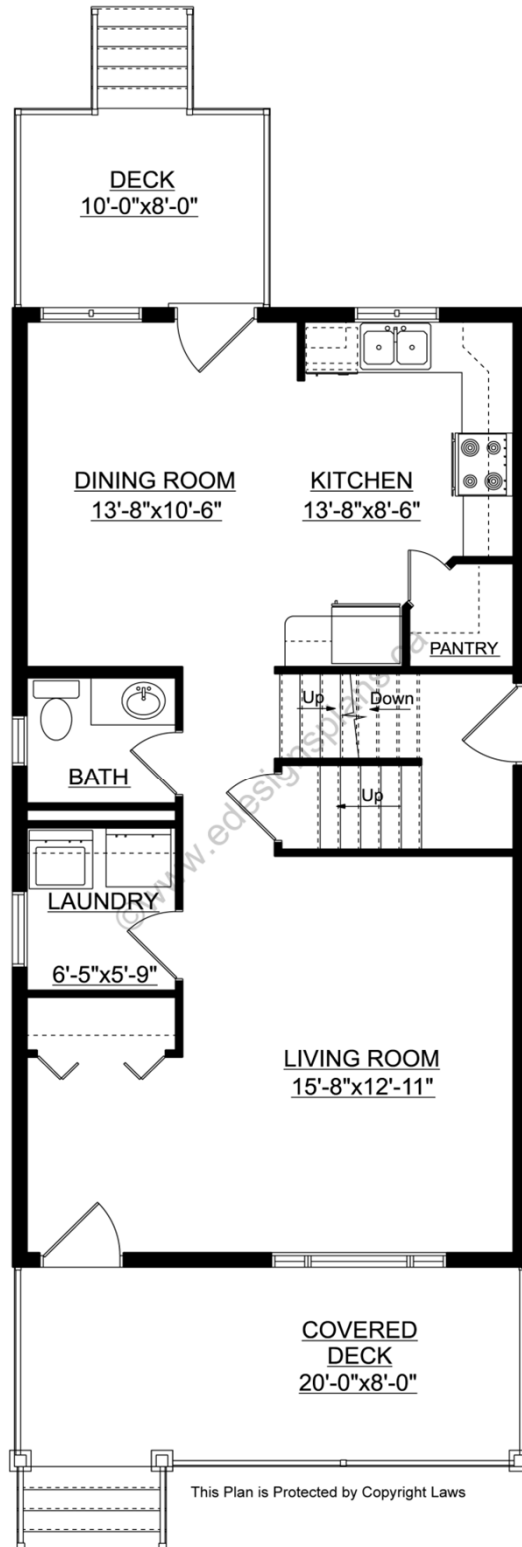

PROTECTED BY COPYRIGHT LAWS.
PROPERTY OF **E-DESIGNS PLANS INC.**

E-Designs Plans Inc.

A western Canadian company from Alberta that designs and ships home plans all across Canada, the US, and Overseas.

For more information about this plan contact the designer at: info@edesignsplans.ca.

Plan 2016986

www.edesignsplans.ca

Call Us 1-855-675-1800

Second Floor

Basement

