

E-Designs Plans Inc.

A western Canadian company from Alberta that designs and ships home plans all across Canada, the US, and Overseas.

For more information about this plan contact the designer at: info@edesignsplans.ca.

Plan #: 2003195 Front Elevation

www.edesignsplans.ca

Call Us 1-855-675-1800



Side Elevation



Bi-Level 4-Plex Plan

1388 Sq. Ft. Total Living Area Per Unit

Width: 39'-8"
 Depth: 70'-0" (plus decks)
 Bedrooms: 3 per unit
 Bathrooms: 2 per unit
 Laundry: Main Floor
 Walk-in Pantry: Yes
 Office/Den: No

Plan #: 2003195

Exterior Walls: 2x6 x 8 Ft. (Main Floor)
 Foundation: 4'-6" 2x6 Pony Wall on 4' Concrete (Other Foundations Available)
 Special Ceilings: None
 Fireplace: No
 Deck(s): Front & Rear
 Veranda: No
 Attached Garage: No
 Finished Basement Plan: Yes

1388 Sq. Ft. Bi-Level 4-Plex: This plan has front and rear decks so it will fit on a 50 foot lot. Split side entry, large L-shaped kitchen with working island with a lunch bar, walk-in corner pantry and dishwasher. The bright nook area with double garden doors leads to a nice size deck. Large size living room and main floor laundry. The lower level has two spare bedrooms, a master bedroom, and a 3-piece bath. Also, the mechanical room and some extra storage space under the stairs. Nice sized basement windows. Simple to build and would make a good investment property.

PROTECTED BY COPYRIGHT LAWS.
 PROPERTY OF **E-DESIGNS PLANS INC.**

E-Designs Plans Inc.

A western Canadian company from Alberta that designs and ships home plans all across Canada, the US, and Overseas.

For more information about this plan contact the designer at: info@edesignsplans.ca.

Plan 2003195

www.edesignsplans.ca

Call Us 1-855-675-1800

Main Floor

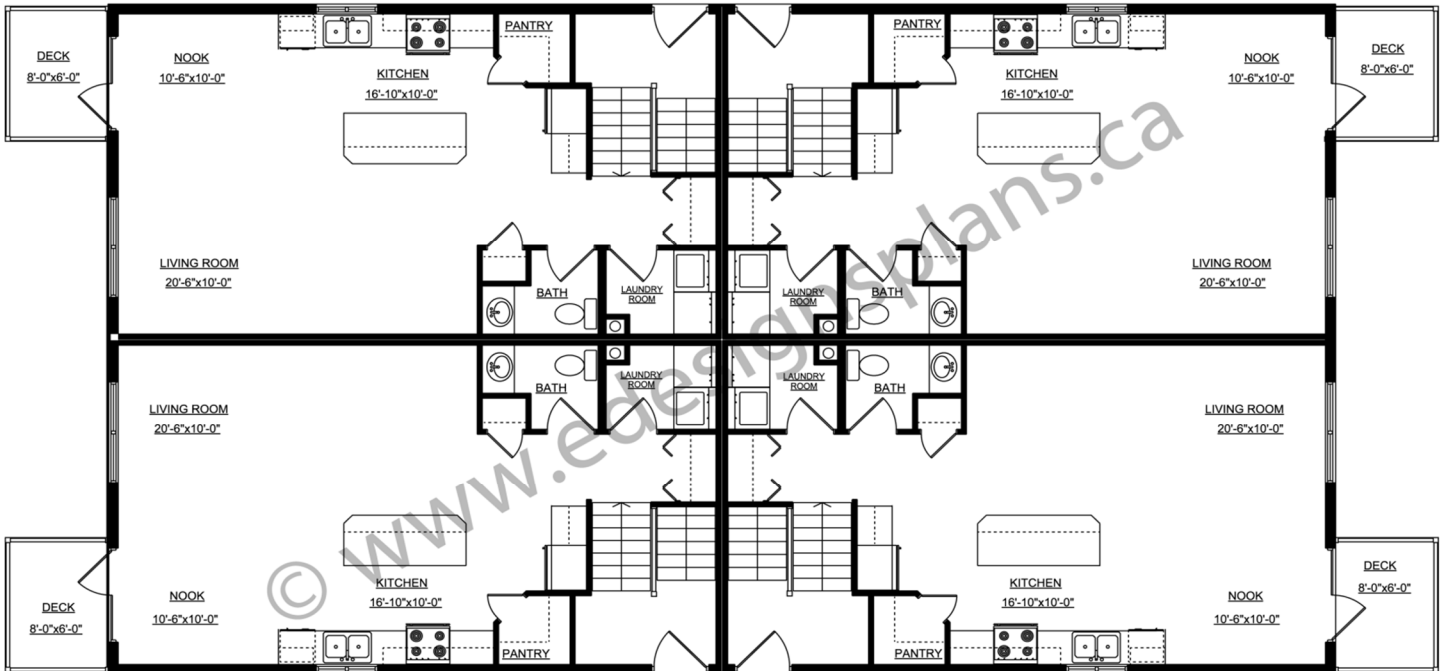

This Plan is Protected by Copyright Laws

Lower Floor

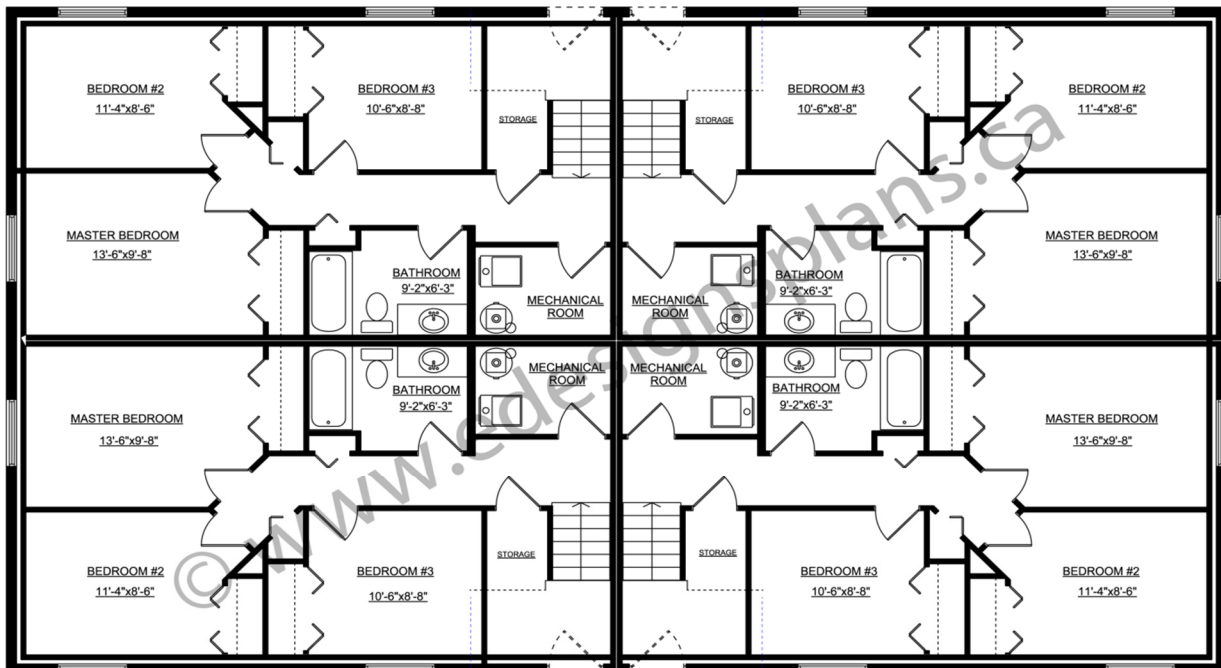

This Plan is Protected by Copyright Laws

PROTECTED BY COPYRIGHT LAWS.
PROPERTY OF **E-DESIGNS PLANS INC.**