

E-Designs Plans Inc.

A western Canadian company from Alberta that designs and ships home plans all across Canada, the US, and Overseas.

For more information about this plan contact the designer at: info@edesignsplans.ca.

Plan #: 2008428 Front Elevation

www.edesignsplans.ca

[Call Us 1-855-675-1800](tel:1-855-675-1800)



Side Elevation



2-Storey 4-Plex

1146 Sq. Ft. Total Living Area Per Unit

Width: 40'-0" plus steps
Depth: 66'-0" incl. veranda
Bedrooms: 2 per unit
Bathrooms: 2 & a Half per unit
Laundry: Second Floor
Walk-in Pantry: No
Office/Den: No
Finished Basement Plan: No

Plan #: 2008428

Exterior Walls: 2x6 x 8 Ft. (Main Floor)
2x6 x 8 Ft. (Second Floor)
Foundation: 8' Concrete Wall
(Other Foundations Available)
Special Ceilings: None
Fireplace: No
Deck(s): No
Veranda: Yes
Attached Garage: No

2-Storey 4-Plex with 1146 Sq. Ft. Per Unit. Designed to easily fit a 50 foot lot, the front and rear of this 4-Plex has an elegant look which gives it great curb appeal. The dropped front entry minimizes the front steps to two, yet still allows for a full basement which can be easily developed as the joists are clear span (no posts). A very open floor plan. The full kitchen and dining area together look into the living room with a cantilevered niche area. Extra space beside the stairway is a great place for a computer desk or media centre. The side door makes it convenient to access the barbecue or play area. The second floor has nice large bedrooms with the master having a 3-piece ensuite and a large closet. No need to do the laundry down in the basement with the washer and dryer on the second floor. A great all around 4-Plex with style and simplicity in building.

PROTECTED BY COPYRIGHT LAWS.
PROPERTY OF ***E-DESIGNS PLANS INC.***

E-Designs Plans Inc.

A western Canadian company from Alberta that designs and ships home plans all across Canada, the US, and Overseas.

For more information about this plan contact the designer at: info@edesignsplans.ca.

Plan 2008428

www.edesignsplans.ca

[Call Us 1-855-675-1800](tel:1-855-675-1800)

Main Floor

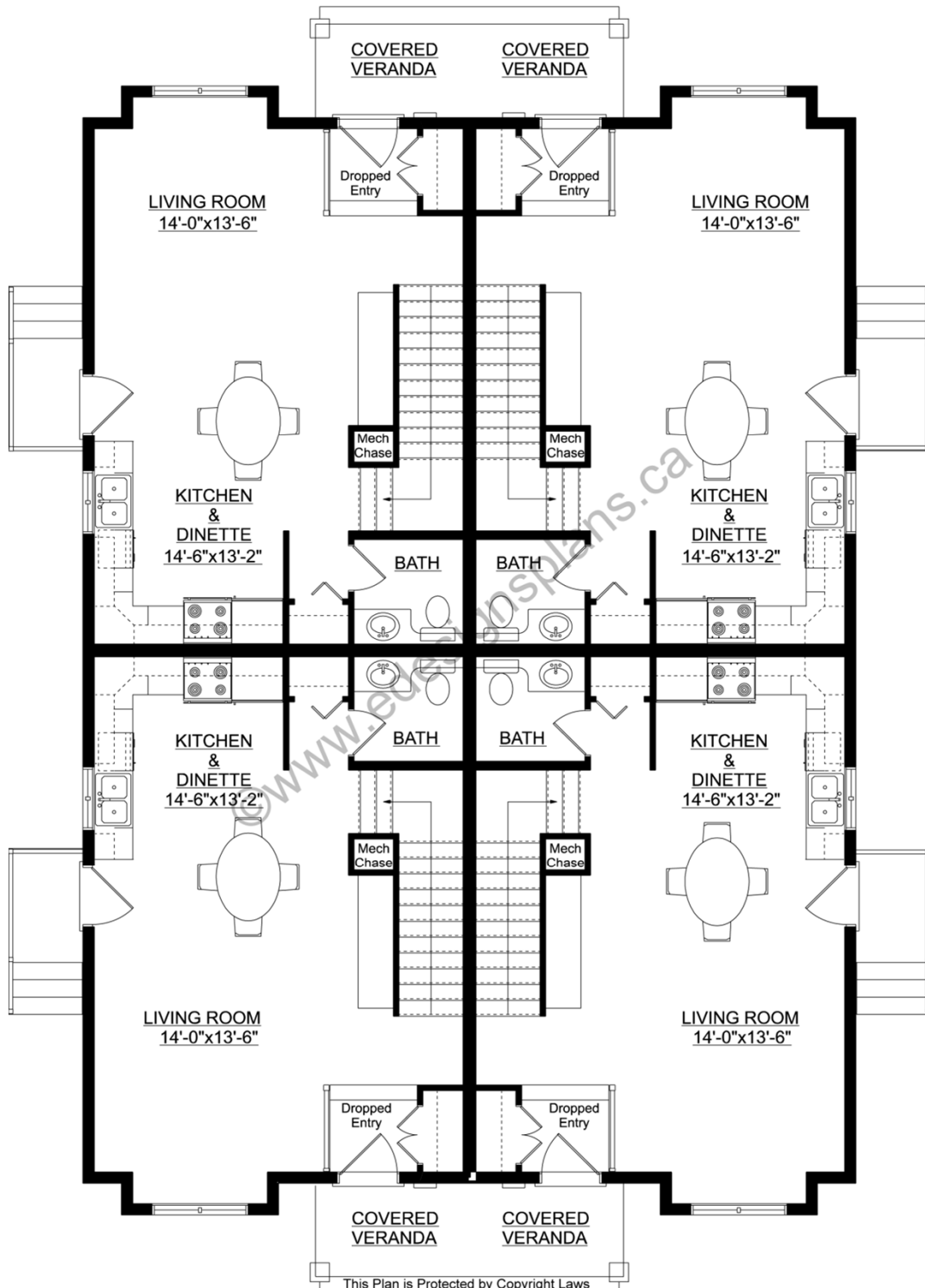

PROTECTED BY COPYRIGHT LAWS.
PROPERTY OF **E-DESIGNS PLANS INC.**

E-Designs Plans Inc.

A western Canadian company from Alberta that designs and ships home plans all across Canada, the US, and Overseas.

For more information about this plan contact the designer at: info@edesignsplans.ca.

Plan 2008428

www.edesignsplans.ca

[Call Us 1-855-675-1800](tel:1-855-675-1800)

Second Floor

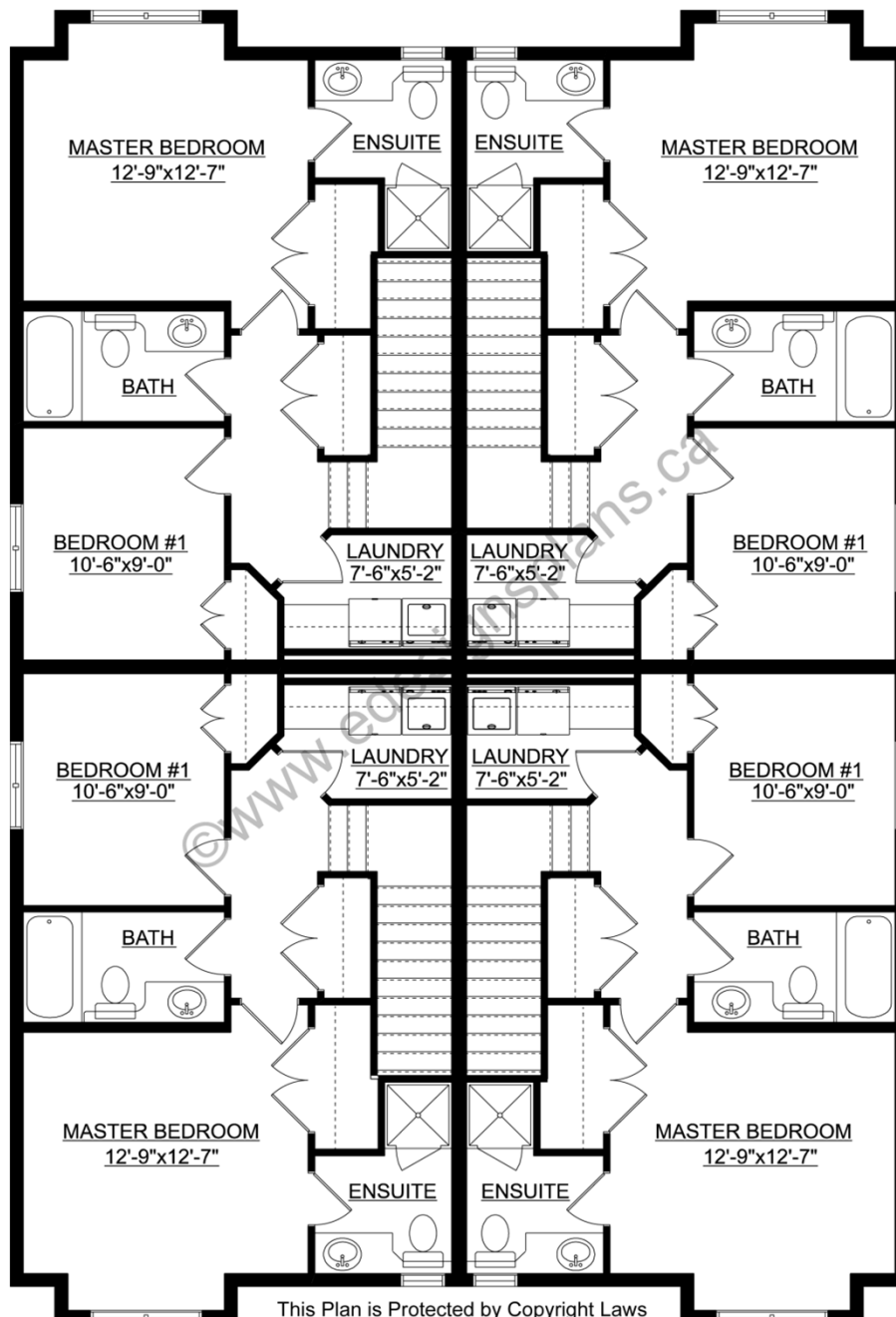

PROTECTED BY COPYRIGHT LAWS.
PROPERTY OF **E-DESIGNS PLANS INC.**