

E-Designs Plans Inc.

A western Canadian company from Alberta that designs and ships home plans all across Canada, the US, and Overseas.

For more information about this plan contact the designer at: info@edesignsplans.ca.

Plan #: 2011544 Front Elevation

www.edesignsplans.ca

Call Us 1-855-675-1800



Side Elevation



4-Plex Plan

1142 Sq. Ft. per Unit Plus Basement

Width: 40'-0"
 Depth: 72'-0"
 Bedrooms: 2 per Unit
 Bathrooms: 3 per Unit
 Laundry: Second Floor
 Walk-in Pantry: No
 Office/Den: No
 Finished Basement Plan: No

Plan #: 2011544

Exterior Walls: 2x6 x 8 Ft. (Main Floor)
 2x6 x 8 Ft. (Second Floor)
 Foundation: 4' 2x6 Pony Wall on 4' ICF
 (Insulated Concrete Form)
 (Other Foundations Available)
 Special Ceilings: No
 Fireplace: No
 Deck(s): Yes (Covered)
 Veranda(s): No (Arctic Entry)
 Attached Garage: No

A Simple Design 4-Plex, but with some Style and Curb Appeal. Designed with what they call an "Arctic Entry" in the northern parts of the country, referred to as a porch in most places. We have taken this basic design, added the front covered decks, wider trim, shutters, vent chases, cantilevered the master bedrooms out 2 feet, added craftsman style posts with some stone work, and magically you have very nice looking building. Still using the "square box" design to keep the costs down, but by adding the above, you have a building that would blend into any area. The porches could be removed and replaced with just a small deck with stairs giving access to the entrance. The full kitchen and nook, together, look into the living room with the boxed out window. A niche area beside the stairway for a computer desk, etc. A pantry just off the kitchen. The second floor has large bedrooms with the master having a 3-piece ensuite and a large walk-in closet. The 3-piece main bath is plenty big. No need to do the laundry down in the basement with the washer & dryer on the second floor. This room is large enough to use for storage also. Provisions have been made for vented heating appliance or direct venting. A great all around 4-plex with style and simplicity in design.

PROTECTED BY COPYRIGHT LAWS.
 PROPERTY OF **E-DESIGNS PLANS INC.**

E-Designs Plans Inc.

A western Canadian company from Alberta that designs and ships home plans all across Canada, the US, and Overseas.

For more information about this plan contact the designer at: info@edesignsplans.ca.

Plan 2011544

www.edesignsplans.ca

Call Us 1-855-675-1800

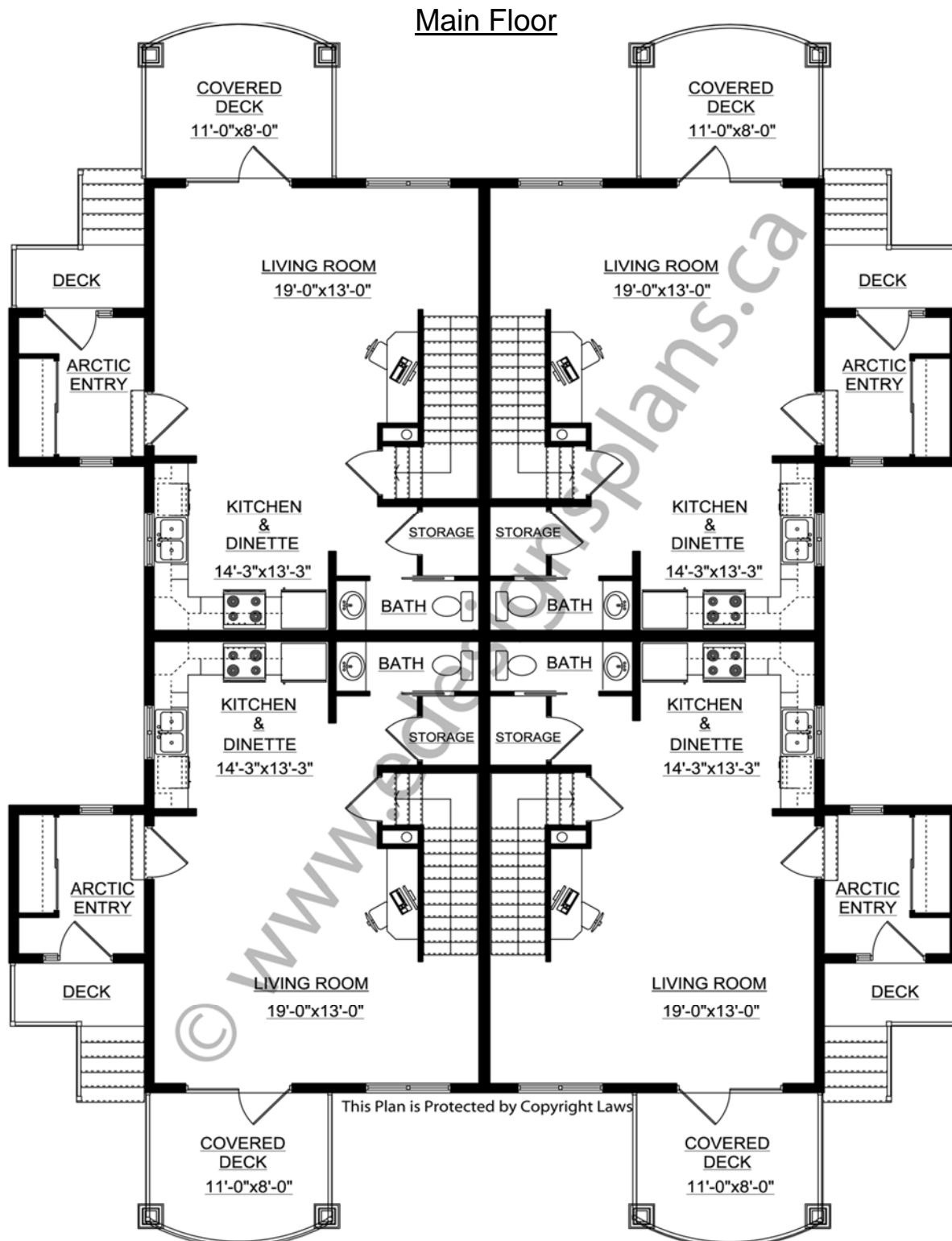

PROTECTED BY COPYRIGHT LAWS.
PROPERTY OF **E-DESIGNS PLANS INC.**

E-Designs Plans Inc.

A western Canadian company from Alberta that designs and ships home plans all across Canada, the US, and Overseas.

For more information about this plan contact the designer at: info@edesignsplans.ca.

Plan 2011544

www.edesignsplans.ca

[Call Us 1-855-675-1800](tel:1-855-675-1800)

Second Floor

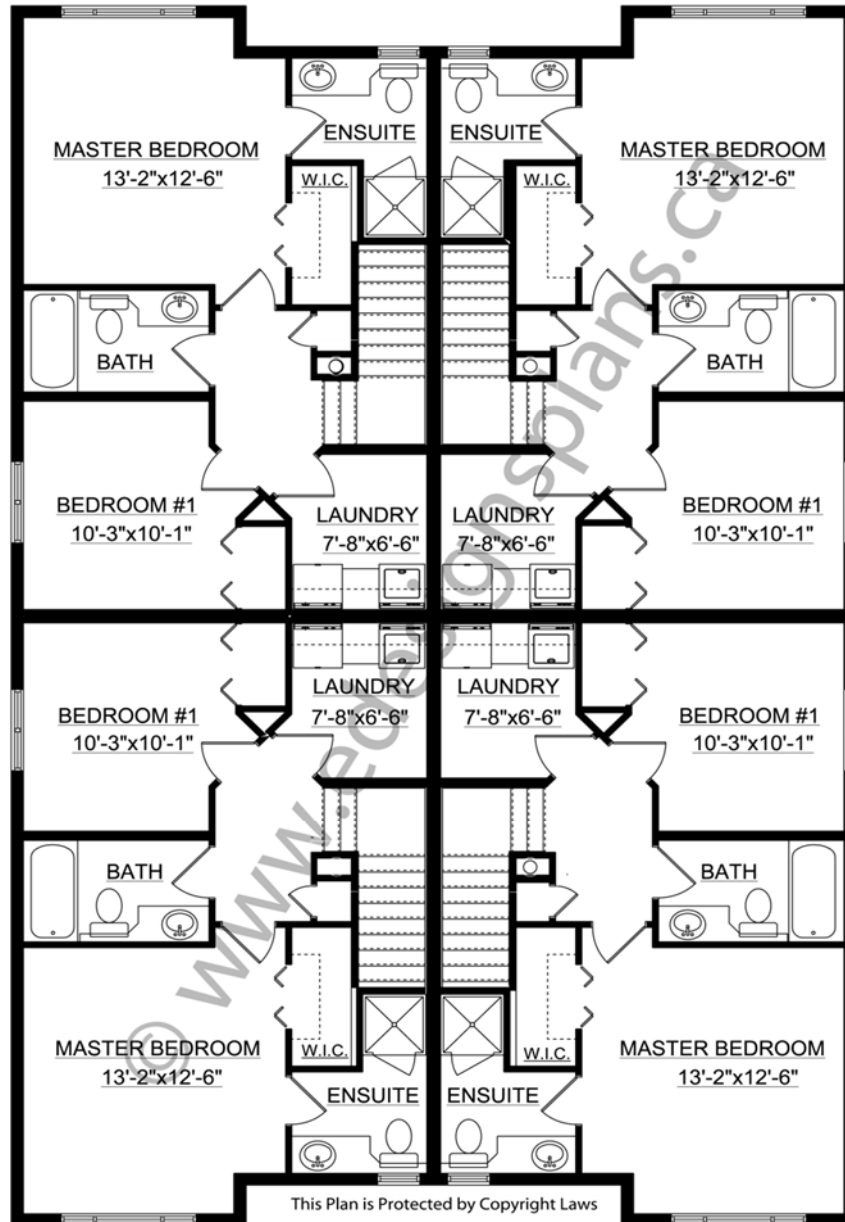

This Plan is Protected by Copyright Laws

PROTECTED BY COPYRIGHT LAWS.
PROPERTY OF **E-DESIGNS PLANS INC.**