

# E-Designs Plans Inc.

A western Canadian company from Alberta that designs and ships home plans all across Canada, the US, and Overseas.

For more information about this plan contact the designer at: [info@edesignsplans.ca](mailto:info@edesignsplans.ca).

**Plan #: 2011590 Front Elevation**

[www.edesignsplans.ca](http://www.edesignsplans.ca)

**Call Us 1-855-675-1800**



**Side Elevation**



## **4-Plex with Legal Suites**

**1320 Sq. Ft. Main & Second Floor per Unit**

**535 Sq. Ft. Legal Suites per Unit**

Width: 44'-0"  
Depth: 76'-0"  
Bedrooms: 3 Bedrooms (Rear Units)  
2 Bedrooms (Front Units)  
1 Bedroom (Legal Suites)  
Bathrooms: 3 per Unit  
Laundry: Second & Lower Floors

## **Plan #: 2011590**

Exterior Walls:	2x6 x 8 Ft. (Main Floor) 2x6 x 8 Ft. (Second Floor)
Foundation:	9' ICF (Insulated Concrete Form) (Other Foundations Available)
Floor Systems:	16" Open Web (Clear Span)
Fireplace:	No
Deck(s):	Yes
Veranda:	No
Attached Garage:	No
Finished Basement Plan:	Yes (Legal Suites)

**4-Plex with Legal Suites.** This is the same "Great Revenue Generator" as 2011576, but **4 feet wider**, not only making the bedrooms that much bigger, but adding to the main floor and legal suites' total square footage. This eye catching 4-plex will generate as much revenue as an 8-plex without all the extra costs involved with building a Commercial building (which is anything bigger than a 4-plex). With any building larger than a 4-plex, an engineer must be hired for all the building and mechanical drawings, which could result in thousands of dollars in engineering fees. As more centres are now allowing Legal or Mother-in-Law Suites in duplexes and fourplexes, this allows builders to recoup their investment much sooner. This design is very well laid out to maximize all useable space yet making it very cost effective to build. With the lower level only 4 feet in the ground, each unit has large windows allowing lots of natural lighting. The covered decks with craftsman style posts, stone cladding, large corner trims, window treatments, frieze boards, shutters, dutch gables, and covered side entrances, gives this basic 4-plex plan an aesthetically pleasing look without adding a large expense. One of our best 4-plex plans.

PROTECTED BY COPYRIGHT LAWS.  
PROPERTY OF **E-DESIGNS PLANS INC.**

# E-Designs Plans Inc.

A western Canadian company from Alberta that designs and ships home plans all across Canada, the US, and Overseas.

For more information about this plan contact the designer at: [info@edesignsplans.ca](mailto:info@edesignsplans.ca).

**Plan 2011590**

[www.edesignsplans.ca](http://www.edesignsplans.ca)

**Call Us 1-855-675-1800**

## Main Floor

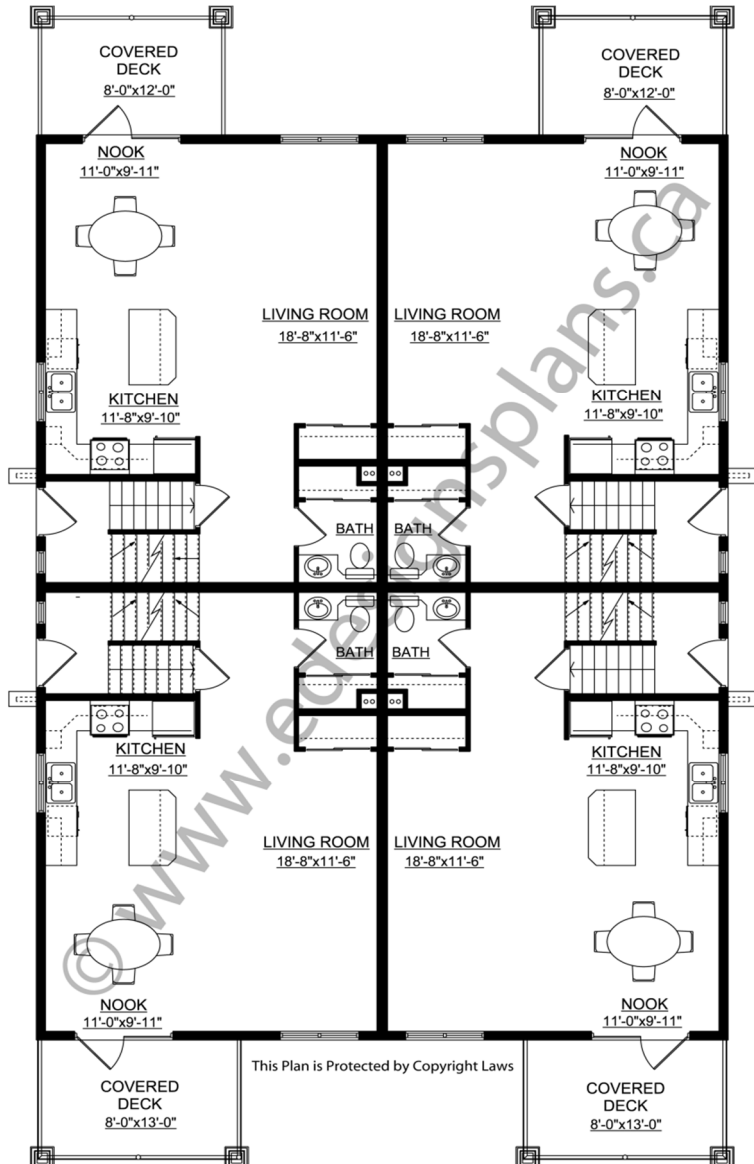

## Second Floor

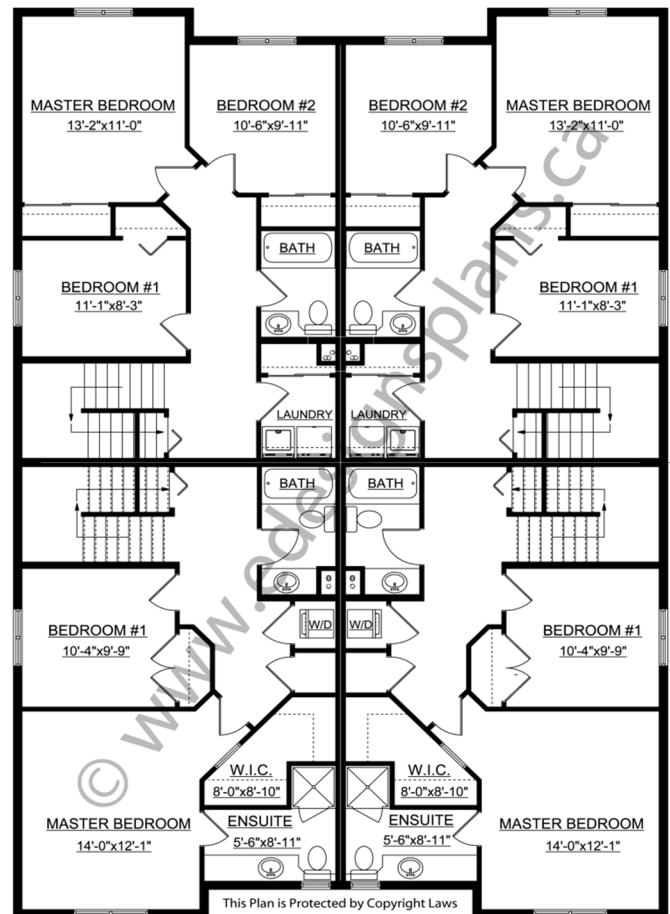

PROTECTED BY COPYRIGHT LAWS.  
PROPERTY OF **E-DESIGNS PLANS INC.**

# ***E-Designs Plans Inc.***

A western Canadian company from Alberta that designs and ships home plans all across Canada, the US, and Overseas.

For more information about this plan contact the designer at: [info@edesignsplans.ca](mailto:info@edesignsplans.ca).

Plan 2011590

[www.edesignsplans.ca](http://www.edesignsplans.ca)

[Call Us 1-855-675-1800](tel:1-855-675-1800)

## Lower Floor

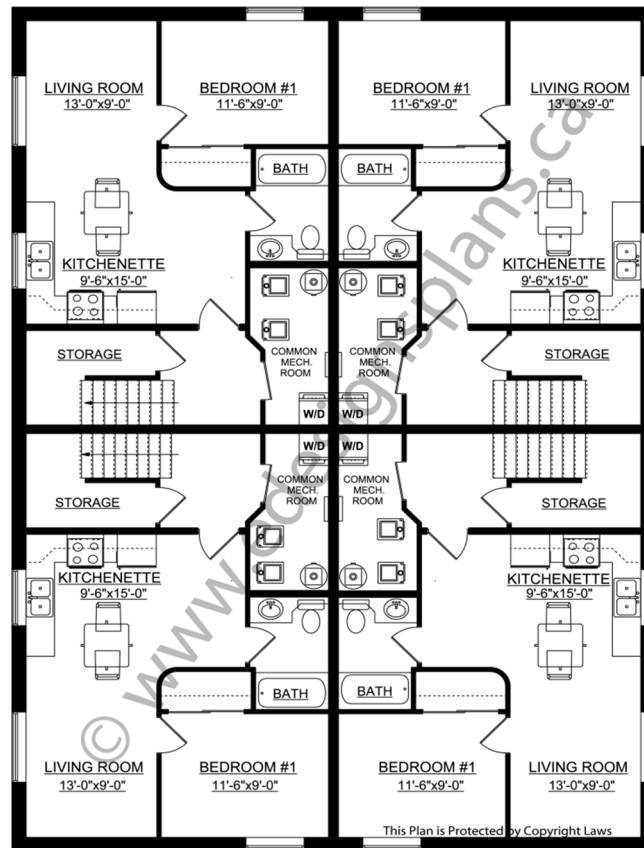

PROTECTED BY COPYRIGHT LAWS.  
PROPERTY OF **E-DESIGNS PLANS INC.**