

# ***E-Designs Plans Inc.***

A western Canadian company from Alberta that designs and ships home plans all across Canada, the US, and Overseas.

For more information about this plan contact the designer at: [info@edesignsplans.ca](mailto:info@edesignsplans.ca).

**Plan #: 2012646 Front Elevation**

[www.edesignsplans.ca](http://www.edesignsplans.ca)

**Call Us 1-855-675-1800**



**Side Elevation**



**Bi-Level 4-Plex Plan**

542 Sq. Ft. Main Floor Per Unit

408 Sq. Ft. Lower Floor Per Unit

**950 Sq. Ft. Total Living Area Per Unit**

Width:	42'-0"
Depth:	66'-0" (incl. decks)
Bedrooms:	2/unit
Bathrooms:	2/unit
Main Floor Laundry:	Yes
Walk-in Pantry:	No

**Plan #: 2012646**

Exterior Walls:

Foundation:

Floor System:

Special Ceilings:

Fireplace:

Deck(s):

Attached Garage:

Finished Basement Plan:

Separate Mechanical Rms:

2x6 x 9 Ft. (Main Floor)

9' Concrete Foundation

(Other Foundations Available)

Ceiling Span 16" Open Web

No

Yes

Front & Rear

No

Yes

Yes

**Great Curb Appeal with this Bi-Level 4-Plex.** This design has been taken from one of our other very popular 4-Plex Plans, 2011576, but we have removed one floor. From the split side entrance and up a few stairs, here you have an L-shaped kitchen featuring a large working island with a lunch bar. The kitchen is open to the nook and living room. Patio doors lead you onto a covered deck area. There are two closets and room for a stackable washer and dryer on this level. There is also a two piece bath. Down to the lower level, you will find two large bedrooms. The master bedroom features a walk-in closet. The mechanical room is next to the 3-piece main bath. All the windows in the lower level are 40" high which allows for lots of natural lighting. This 4-Plex Plan would fit great in any neighbourhood.

# E-Designs Plans Inc.

A western Canadian company from Alberta that designs and ships home plans all across Canada, the US, and Overseas.

For more information about this plan contact the designer at: [info@edesignsplans.ca](mailto:info@edesignsplans.ca).

**Plan 2012646**

[www.edesignsplans.ca](http://www.edesignsplans.ca)

**Call Us 1-855-675-1800**

## Main Floor

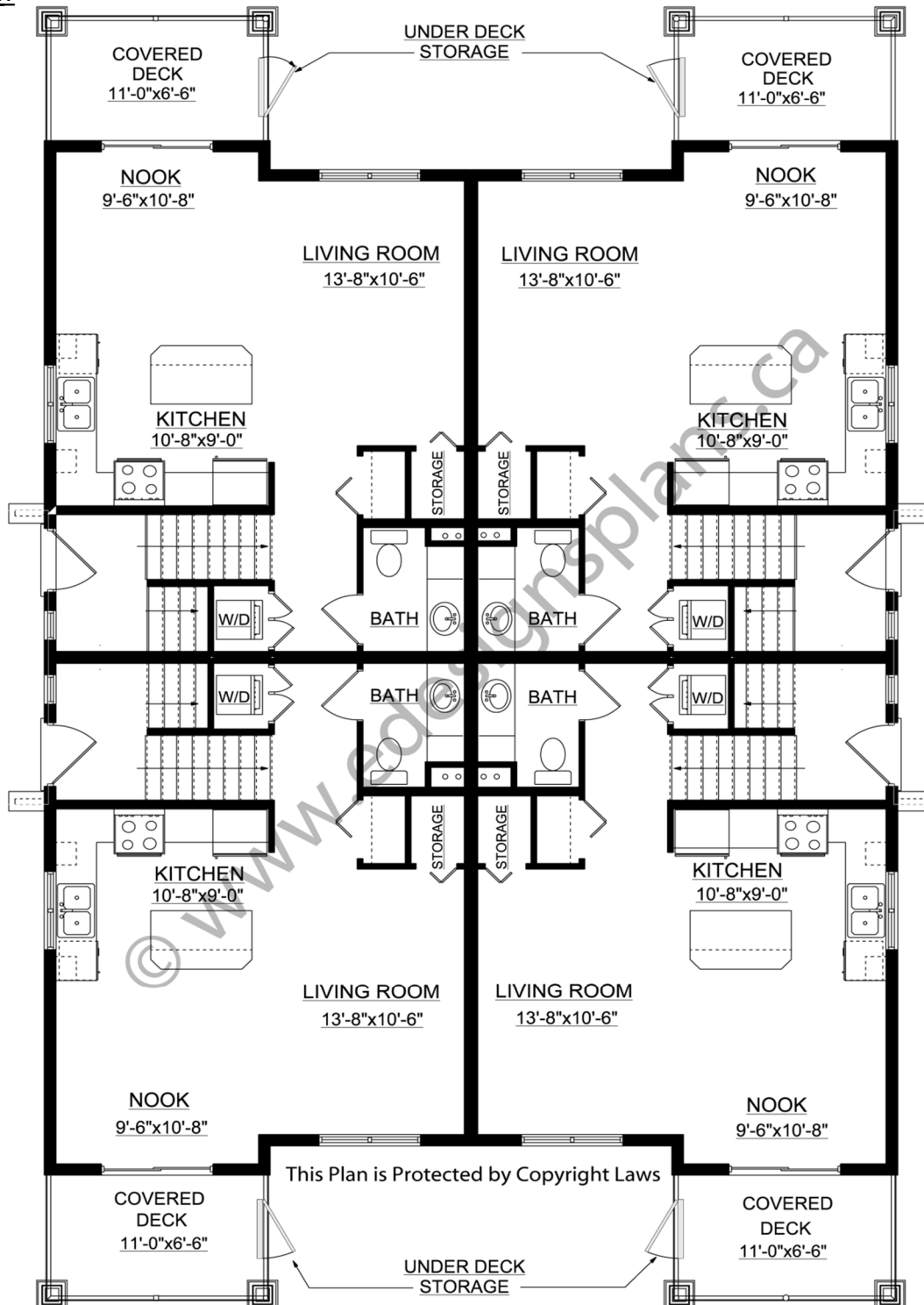

PROTECTED BY COPYRIGHT LAWS.  
PROPERTY OF **E-DESIGNS PLANS INC.**

# E-Designs Plans Inc.

A western Canadian company from Alberta that designs and ships home plans all across Canada, the US, and Overseas.

For more information about this plan contact the designer at: [info@edesignsplans.ca](mailto:info@edesignsplans.ca).

Plan 2012646

[www.edesignsplans.ca](http://www.edesignsplans.ca)

Call Us 1-855-675-1800

## Lower Floor

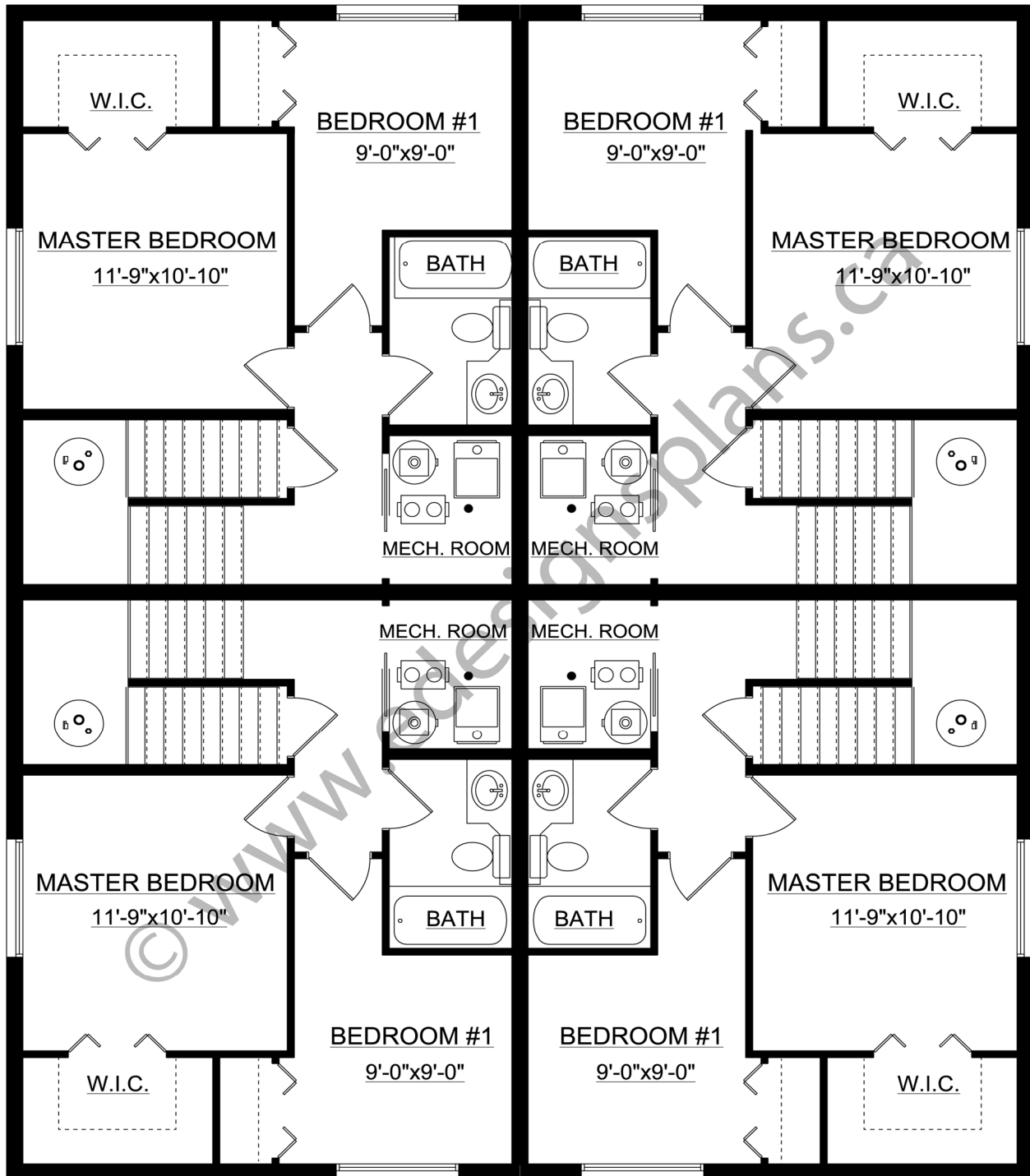

This Plan is Protected by Copyright Laws

PROTECTED BY COPYRIGHT LAWS.  
PROPERTY OF **E-DESIGNS PLANS INC.**