

E-Designs Plans Inc.

A western Canadian company from Alberta that designs and ships home plans all across Canada, the US, and Overseas.

For more information about this plan contact the designer at: info@edesignsplans.ca.

Plan #: 2012662 Front Elevation

www.edesignsplans.ca

Call Us 1-855-675-1800



Side Elevation



4-Plex Plan With Legal Suites

1224 Sq. Ft. Per Unit

490 Sq. Ft. Per Legal Suite

Width: 40'-0"
Depth: 76'-0"
Bedrooms: 3 per unit
Bathrooms: 2 per unit
Laundry: Second Floor
Suites: Kitchenette, Living Room,
Bathroom, Laundry, Mech.
& Storage Room

Plan #: 2012662

Exterior Walls:	2x6 x 8 Ft. (Main & Second Floors)
Foundation:	9 Ft. ICF (Insulated Concrete Form) (Other Foundations Available)
Special Ceilings:	None
Covered Deck(s):	Front & Rear
Attached Garage:	No
Finished Basement Plan:	Yes
Separate Mechanical:	Yes
Floor System:	16" Open Web
Note:	All units have Separate Entrances

2-Storey 4-Plex designed with Mother-in-Laws Suites This design is similar to others on this website but with a couple of differences. Notable are the Separate Entrances for each suite. A four wide separate stairway goes to each unit. Also, each unit has its own mechanical room and laundry room. These units are totally self contained. The main floor plan has an L-shaped kitchen and is open to the dining and living rooms. A working island with a lunch bar is also featured in this layout. The mechanical room, along with a 2-piece bath are also on this floor. Up to the second floor, here you will find three nice-sized bedrooms with closets. There is a laundry room next to the 3-piece bath. The Mother-in-Law suites have their own private entrances too. There is room for storage next to the stairway. These units have their own mechanical and laundry rooms. The L-shaped kitchenette is open to the living room. The 3-piece bath is next to the bedroom. With 30 inch high windows in this level, you get lots of natural lighting. Another great 4-Plex Plan to maximize your investment. Always verify with your local building inspections department to ensure that they allow the suites in the lower level.

PROTECTED BY COPYRIGHT LAWS.
PROPERTY OF **E-DESIGNS PLANS INC.**

For more information about this plan contact the designer at: info@edesignsplans.ca.

Call Us 1-855-675-1800



PROTECTED BY COPYRIGHT LAWS.
PROPERTY OF **E-DESIGNS PLANS INC.**

E-Designs Plans Inc.

A western Canadian company from Alberta that designs and ships home plans all across Canada, the US, and Overseas.

For more information about this plan contact the designer at: info@edesignsplans.ca.

Plan 2012662

www.edesignsplans.ca

[Call Us 1-855-675-1800](tel:1-855-675-1800)

Lower Floor

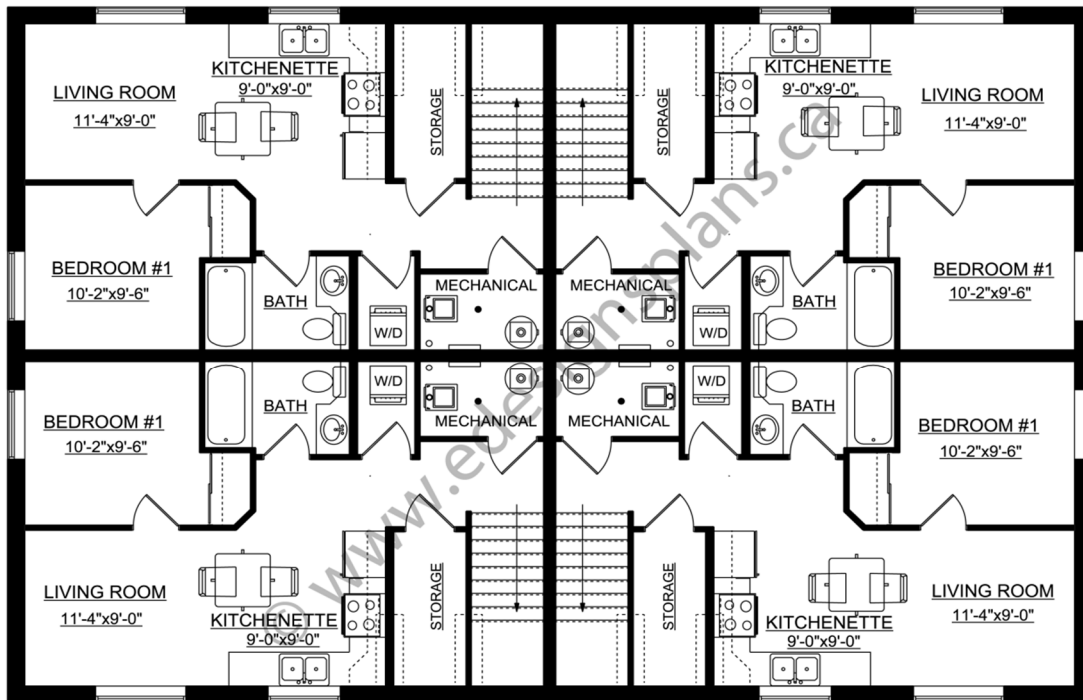

This Plan is Protected by Copyright Laws

PROTECTED BY COPYRIGHT LAWS.
PROPERTY OF **E-DESIGNS PLANS INC.**