

E-Designs Plans Inc.

A western Canadian company from Alberta that designs and ships home plans all across Canada, the US, and Overseas.

For more information about this plan contact the designer at: info@edesignsplans.ca.

Plan #: 2018202 Front Elevation

www.edesignsplans.ca

Call Us 1-855-675-1800



Side Elevation

2-Storey 4-Plex - Side Entrances

510 Sq. Ft. Main Floor per Unit
 534 Sq. Ft. Second Floor per Unit
 1044 Sq. Ft. Total Living Area per Unit
 Width: 34'-0"
 Depth: 72'-0"
 Bedrooms: 2
 Bathrooms: 1 & a Half Bath
 Main Floor Laundry: No
 Walk-in Pantry: No
 Office/Den: No

Plan #: 2018202

Exterior Walls: 2x6 x 8 Ft. (Main Floor)
 2x6 x 8 Ft. (Second Floor)
 Foundation: 9' ICF (Insulated Concrete Form)
 (Other Foundations Available)
 Special Ceilings: None
 Fireplace: No
 Deck(s): Yes (Covered)
 Veranda: No
 Attached Garage: No
 Finished Basement Plan: No

2-Storey 4-Plex Plan. An easy to build 4-Plex with side entrances. A half bath is just in from the entrance with a coat closet beside the bathroom. The kitchen, nook and living room are all open concept. A garden door leads to a covered deck. Upstairs is a 2-bedroom layout that share a 3-piece bathroom. Laundry is accommodated in the hallway at the top of the stairs, with a linen closet across. The master bedroom is cantilevered over the lower floor for additional room, and has a walk-in closet as well. The basement is not finished but has room for additional living space or more bedrooms. The mechanical room is on this level.

E-Designs Plans Inc.

A western Canadian company from Alberta that designs and ships home plans all across Canada, the US, and Overseas.

For more information about this plan contact the designer at: info@edesignsplans.ca.

Plan 2018202

www.edesignsplans.ca

Call Us 1-855-675-1800

Main Floor

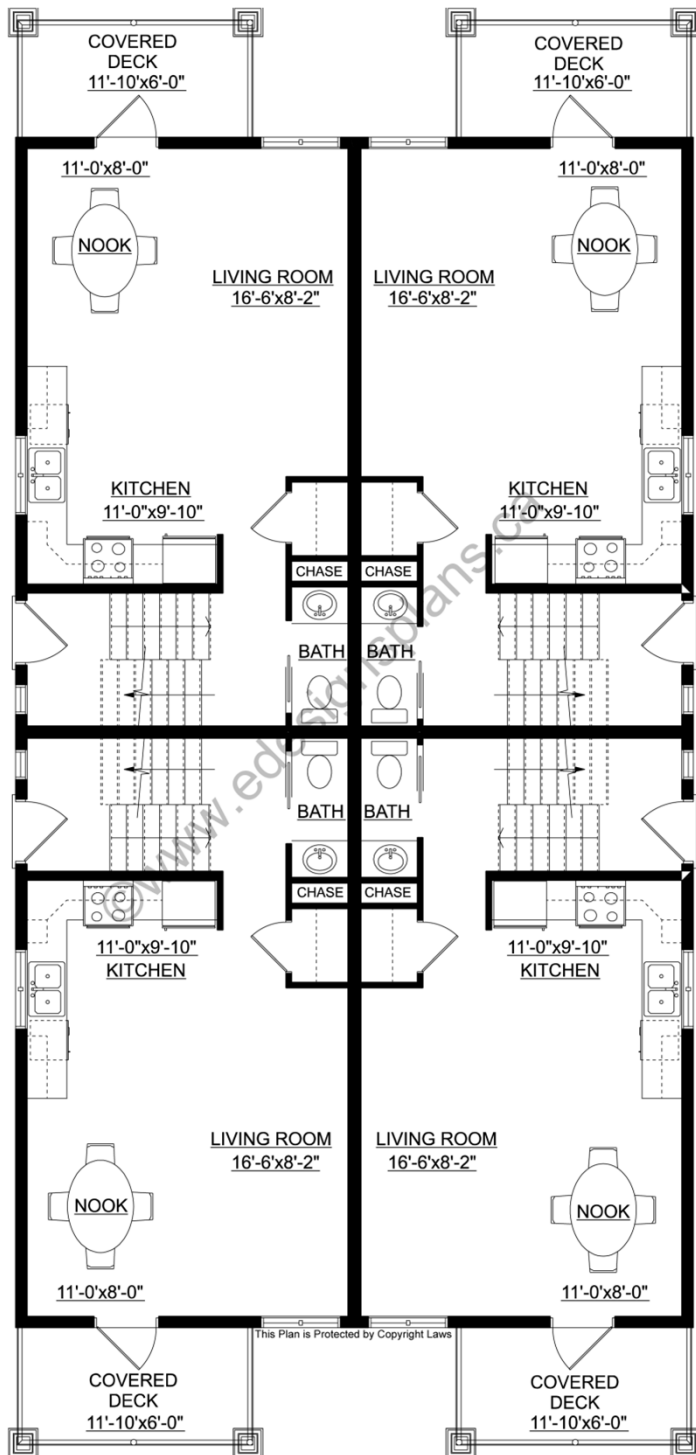

Second Floor

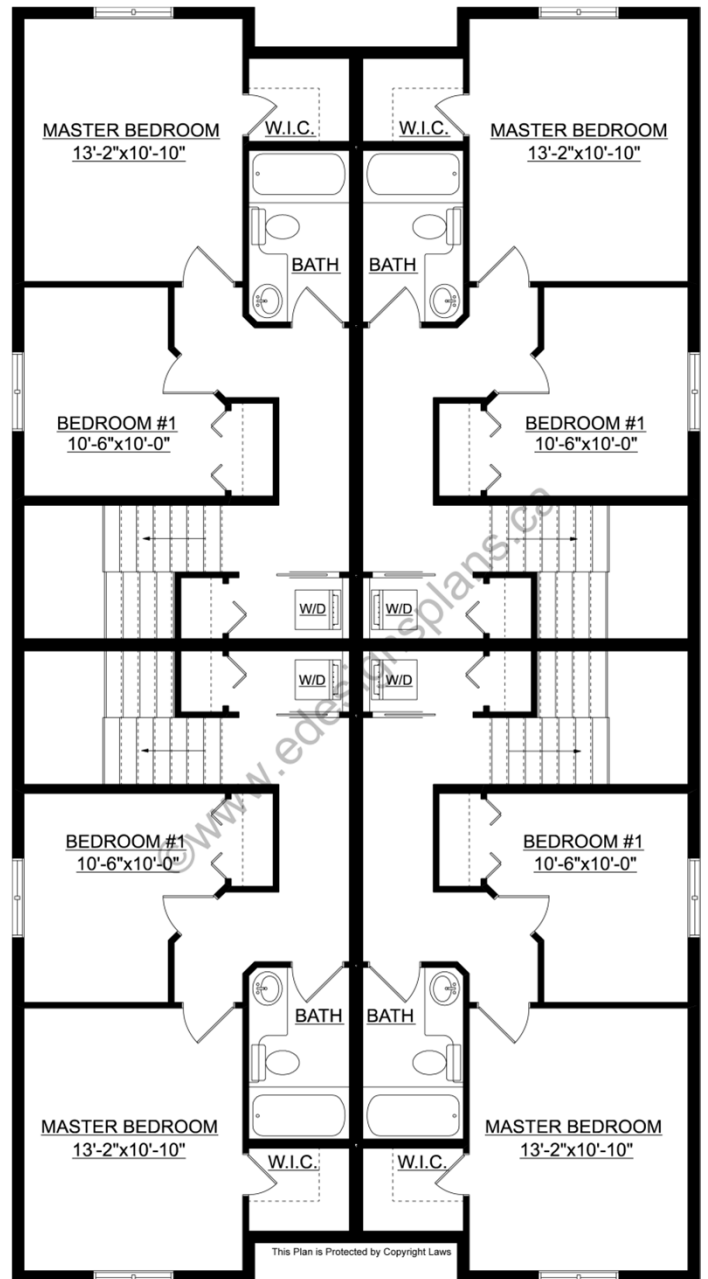

PROTECTED BY COPYRIGHT LAWS.
PROPERTY OF **E-DESIGNS PLANS INC.**