

E-Designs Plans Inc.

A western Canadian company from Alberta that designs and ships home plans all across Canada, the US, and Overseas.

For more information about this plan contact the designer at: info@edesignsplans.ca.

Plan #: 2011583 Front Elevation

www.edesignsplans.ca

Call Us 1-855-675-1800



Side Elevation



4-Plex Plan with Front Garages

1110 Sq. Ft. Main Floor per Side

Width: 100'-0"
Depth: 70'-0"
Bedrooms: 2
Bathrooms: 2
Main Floor Laundry: Yes
Walk-in Pantry: No
Office/Den: No

Plan #: 2011583

Exterior Walls: 2x6 x 8 Ft. (Main Floor)
Foundation: 4' ICF (Insulated Concrete Form) (Other Foundations Available)
Special Ceilings: Vaulted
Fireplace: No
Deck(s): Rear Patios
Veranda(s): Yes (Covered)
Attached Garage: Yes (1-Car each with 9'x7' Door)
Finished Basement Plan: No

4-Plex with Front Garages & Great Curb Appeal. A well thought-out floor plan and an exterior that would look great in any neighborhood. Enter from the covered verandas into the front entry. A full sized closet is located here along with access to a large single car garage. Check out the openness of the great room, dining room and kitchen. And all have vaulted ceilings. The kitchen features a walk-in pantry. The stacking washer/dryer are conveniently located behind the kitchen and close to the bedrooms. A large storage closet also has the access to the crawl space. The master bedroom features a large 3-piece ensuite. A nice-sized guest room is located next to a full 3-piece main bath. This design could also easily be done with a slab on grade.

PROTECTED BY COPYRIGHT LAWS.
PROPERTY OF ***E-DESIGNS PLANS INC.***

E-Designs Plans Inc.

A western Canadian company from Alberta that designs and ships home plans all across Canada, the US, and Overseas.

For more information about this plan contact the designer at: info@edesignsplans.ca.

Plan 2011583

www.edesignsplans.ca

Call Us 1-855-675-1800

Main Floor

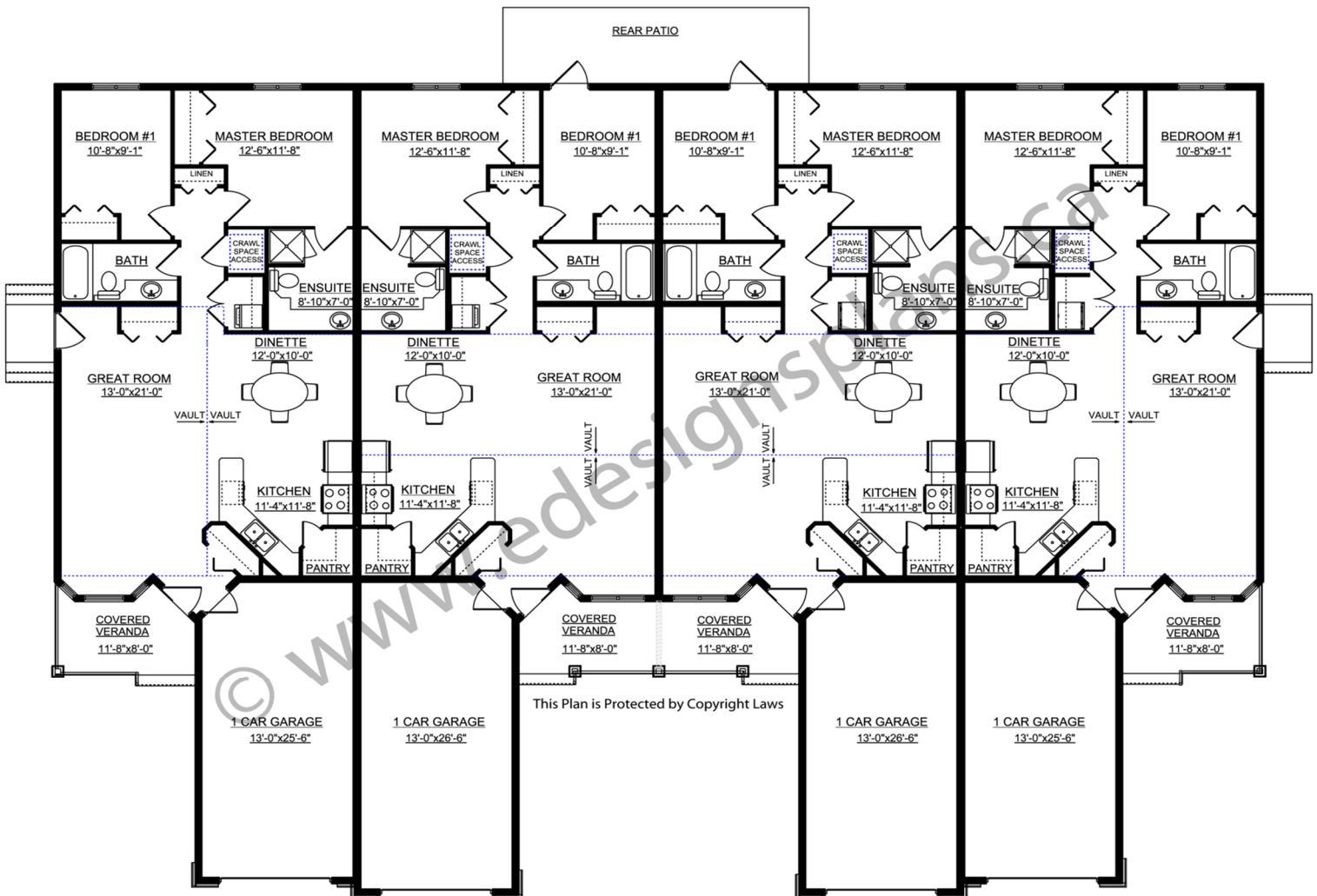

PROTECTED BY COPYRIGHT LAWS.
PROPERTY OF **E-DESIGNS PLANS INC.**