

# *E-Designs* Plans Inc.

A western Canadian company from Alberta that designs and ships home plans all across Canada, the US, and Overseas.

For more information about this plan contact the designer at: [info@edesignsplans.ca](mailto:info@edesignsplans.ca).

**Plan #: 2019253 Front Elevation**

[www.edesignsplans.ca](http://www.edesignsplans.ca)

**Call Us 1-855-675-1800**



**Rear Elevation**



## **2-Storey 4-Plex Plan**

630 Sq. Ft. Main Floor

630 Sq. Ft. Second Floor

1260 Sq. Ft. Total Living Area

Width: 72'-0"

Depth: 41'-0"

Bedrooms: 2

Bathrooms: 1 & a Half Bath

Laundry: Second Floor

Walk-in Pantry: No

Office/Den: No

## **Plan #: 2019253**

Exterior Walls:

2x6 x 8 Ft. (Main Floor)

2x6 x 8 Ft. (Second Floor)

Foundation:

Slab on Grade

(Other Foundations Available)

Special Ceilings:

None

Fireplace:

No

Deck(s):

No

Veranda:

Yes (Covered)

Attached Garage:

No

Finished Basement Plan:

N/A

**2-Storey 4-Plex Plan.** All four units have a covered entry with the centre two units having a larger veranda area separated by a privacy wall. Open concept main floor with a half bath and storage under the stairs. The L-shaped kitchen has an island with seating. Each unit has its own entry from the rear as well as a utility room on the main level. Upstairs is a 2-bedroom design with a larger master bedroom that has its own access access to the 3-piece bathroom with tall linen cabinet. The second bedroom is a nice size as well and has a large walk-in-closet. Laundry is accommodated in the hallway on this level. An easy-to-build fourplex plan.

PROTECTED BY COPYRIGHT LAWS.  
PROPERTY OF ***E-DESIGNS PLANS INC.***

# E-Designs Plans Inc.

A western Canadian company from Alberta that designs and ships home plans all across Canada, the US, and Overseas.

For more information about this plan contact the designer at: [info@edesignsplans.ca](mailto:info@edesignsplans.ca).

Plan 2019253

[www.edesignsplans.ca](http://www.edesignsplans.ca)

[Call Us 1-855-675-1800](tel:1-855-675-1800)

## Main Floor

This Plan is Protected by Copyright Laws

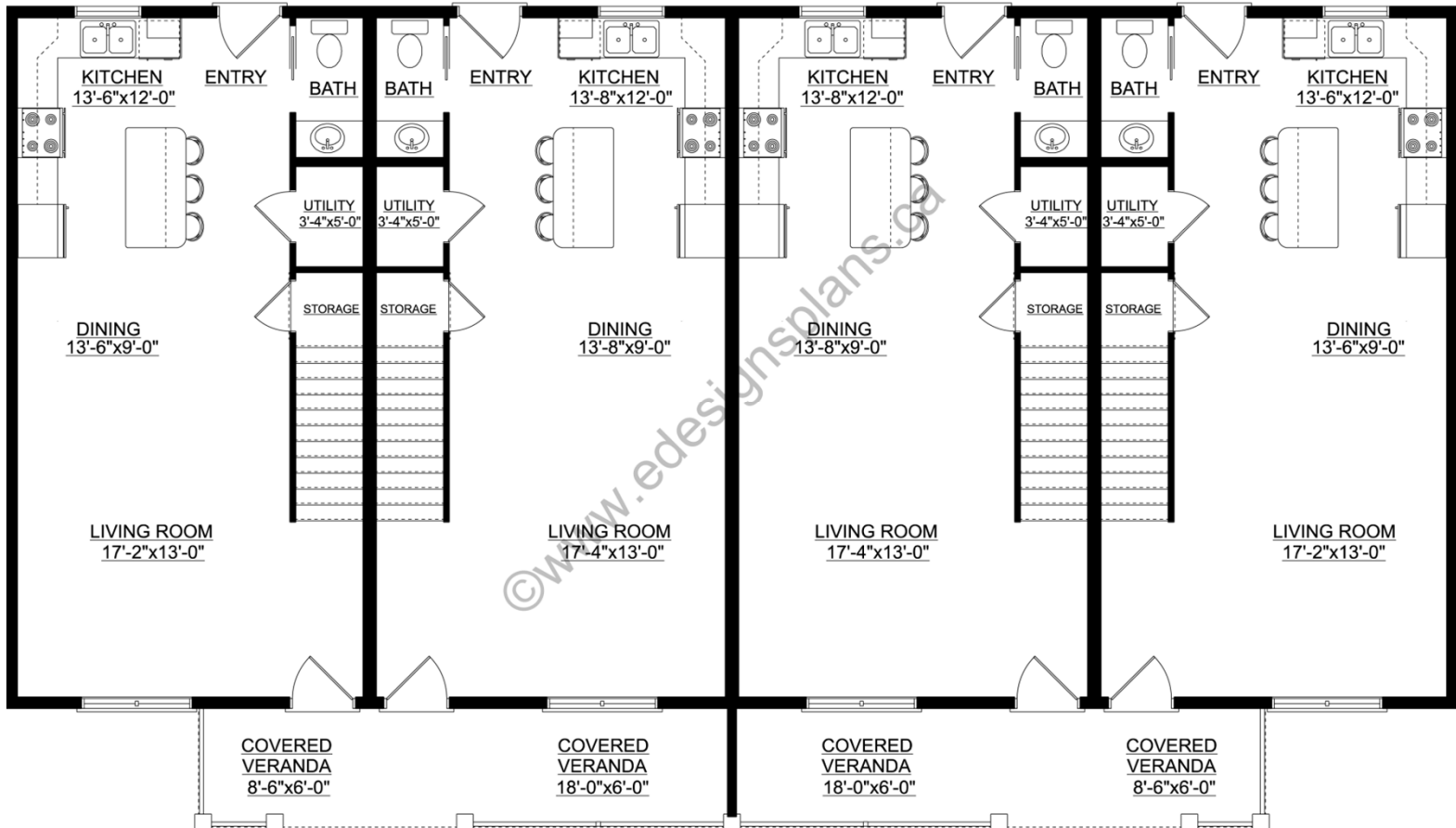

PROTECTED BY COPYRIGHT LAWS.  
PROPERTY OF **E-DESIGNS PLANS INC.**

# E-Designs Plans Inc.

A western Canadian company from Alberta that designs and ships home plans all across Canada, the US, and Overseas.

For more information about this plan contact the designer at: [info@edesignsplans.ca](mailto:info@edesignsplans.ca).

**Plan 2019253**

[www.edesignsplans.ca](http://www.edesignsplans.ca)

**Call Us 1-855-675-1800**

## Second Floor

This Plan is Protected by Copyright Laws

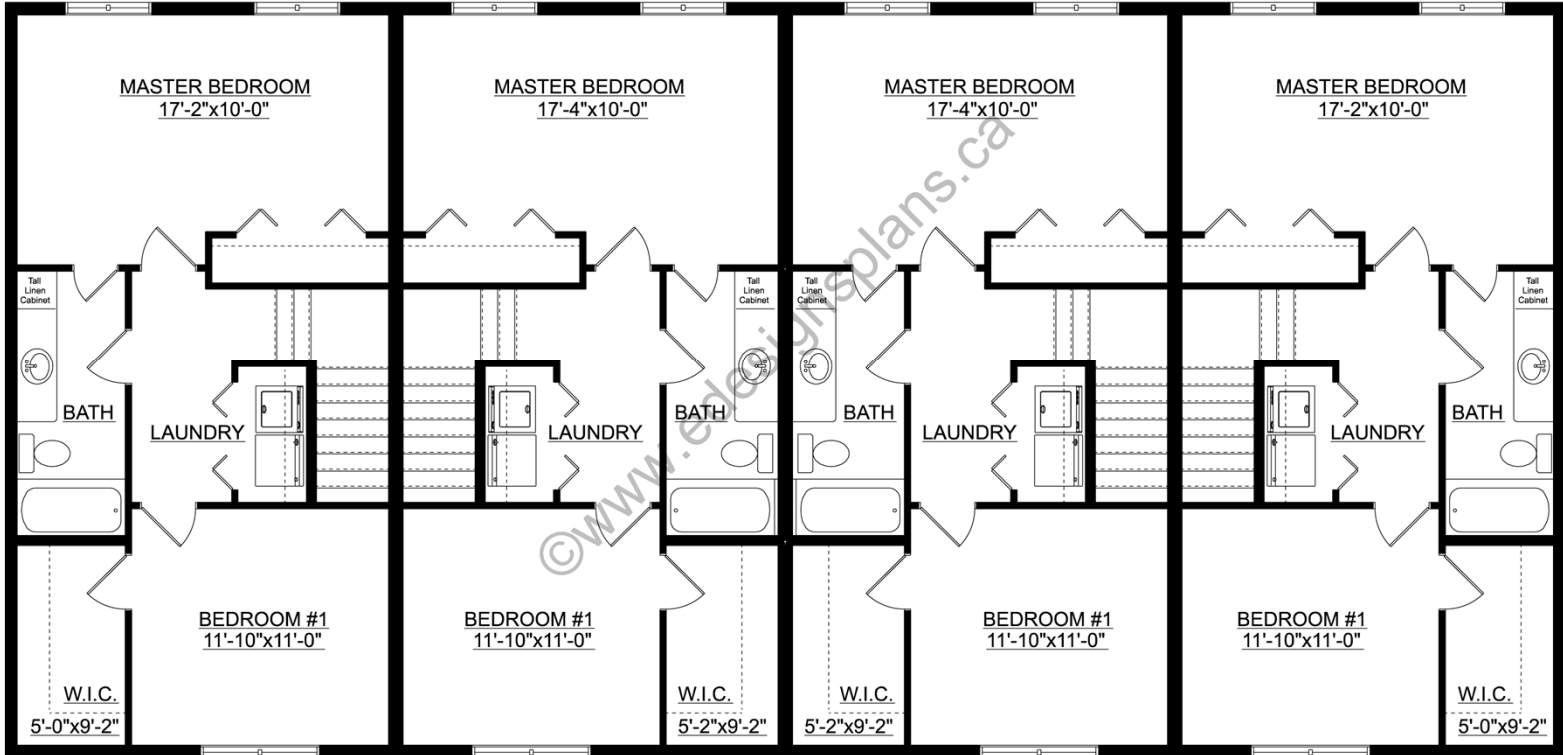

PROTECTED BY COPYRIGHT LAWS.  
PROPERTY OF **E-DESIGNS PLANS INC.**