

E-Designs Plans Inc.

A western Canadian company from Alberta that designs and ships home plans all across Canada, the US, and Overseas.

For more information about this plan contact the designer at: info@edesignsplans.ca.

Plan #: 2010539 Front Elevation

www.edesignsplans.ca

Call Us 1-855-675-1800



Rear Elevation

Modified Bi-Level with 3-Car Garage

1776 Sq. Ft. Main & Second Floor

1180 Sq. Ft. Basement

2956 Sq. Ft. Total Living Area

Width: 61'-2"
 Depth: 58'-0" (plus deck)
 Bedrooms: 4
 Bathrooms: 3
 Main Floor Laundry: Yes
 Walk-in Pantry: Yes
 Office/Den: Yes

Plan #: 2010539

Exterior Walls: 2x6 x 9 Ft. (Main Floor)
 2x6 x 8 Ft. (Second Floor)
 Foundation: 5' 2x6 Pony Wall on 4' Concrete
 (Other Foundations Available)
 Special Ceilings: Vaulted
 Fireplace: Yes (2-Way)
 Deck(s): Rear
 Veranda: No
 Attached Garage: Yes (3-Car - 18'x8' & 10'x10' Doors)
 Finished Basement Plan: Yes

Modified Bi-Level with 3-Car Garage. This home is shown with clean roof lines and contrasting trim & window treatments to give this Bi-level a very stylish appeal. Welcome your guests through the bright front foyer with a large window above the door, which also has 2 sidelights. From the large foyer you can go down to the lower level, into the garage, or enter into the main living area. The 2-piece bath is conveniently located off the garage and front entry. This open plan has a vaulted ceiling. This open plan allows for many options in furniture arrangement centered around the gas fireplace. The double garden doors in the nook extend the entertaining area outdoors via a deck. The kitchen features a layout to provide maximum counter space, lunch bar, and a functional work triangle. Note the oversized walk-in pantry. There are two nice-sized bedrooms located on the main floor accompanied with a large main bath. Up the staircase, a landing leads to an attractive front master suite with its large picture window, convenient walk-in closet, and 5-piece ensuite. In the basement, there is a large spare bedroom next to the home office, or what ever you need it to be. The mechanical room is between the cold storage and the 3-piece bathroom. A small wet bar is in the large family room. The large 3-car garage will be Dad's pride and joy being 25 feet deep.

E-Designs Plans Inc.

A western Canadian company from Alberta that designs and ships home plans all across Canada, the US, and Overseas.

For more information about this plan contact the designer at: info@edesignsplans.ca.

Plan 2010539

www.edesignsplans.ca

Call Us 1-855-675-1800

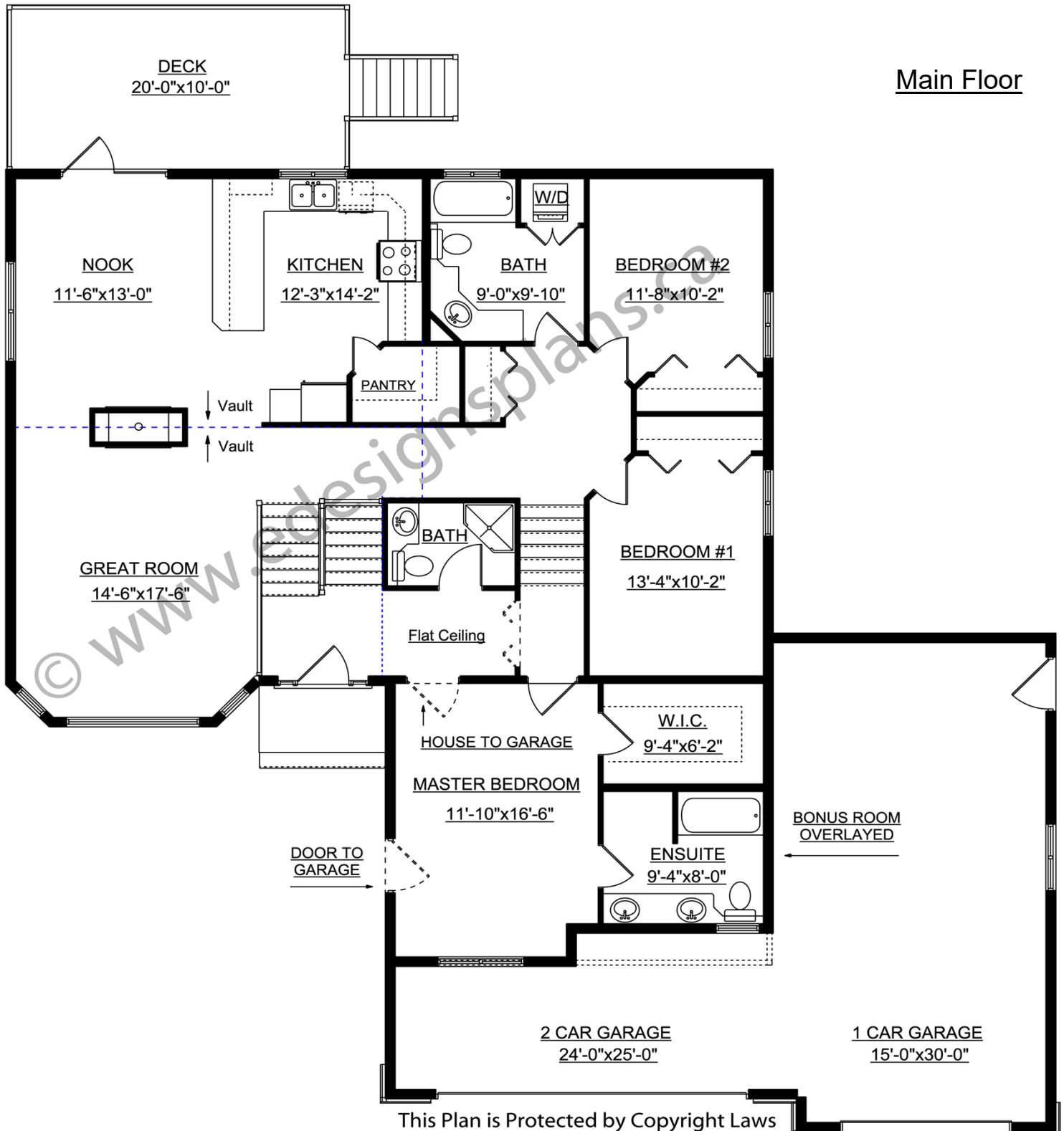

PROTECTED BY COPYRIGHT LAWS.
PROPERTY OF **E-DESIGNS PLANS INC.**

E-Designs Plans Inc.

A western Canadian company from Alberta that designs and ships home plans all across Canada, the US, and Overseas.

For more information about this plan contact the designer at: info@edesignsplans.ca.

Plan 2010539

www.edesignsplans.ca

[Call Us 1-855-675-1800](tel:1-855-675-1800)

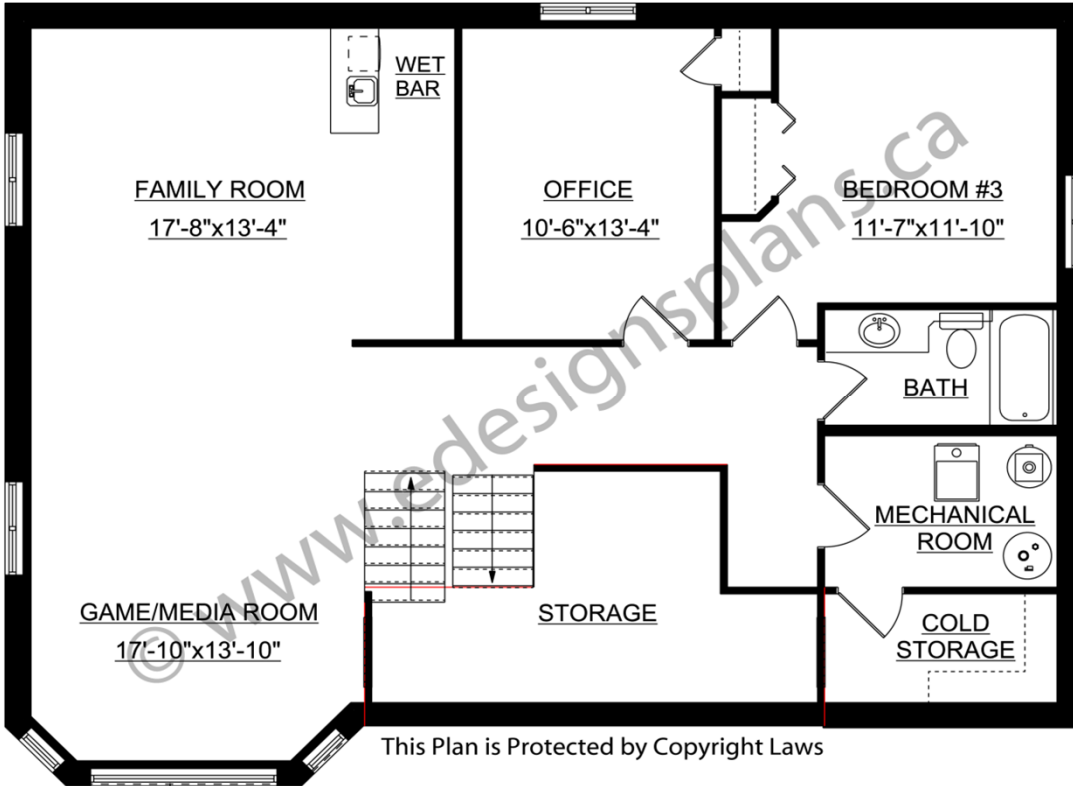

Basement

PROTECTED BY COPYRIGHT LAWS.
PROPERTY OF **E-DESIGNS PLANS INC.**