

E-Designs *Plans Inc.*

A western Canadian company from Alberta that designs and ships home plans all across Canada, the US, and Overseas.

For more information about this plan contact the designer at: info@edesignsplans.ca.

Plan #: 2011553 Front Elevation

www.edesignsplans.ca

Call Us 1-855-675-1800



Rear Elevation

Bi-Level

1196 Sq. Ft. Main Floor

Width: 25'-0"
 Depth: 52'-0" (plus entry)
 Bedrooms: 2
 Bathrooms: 2
 Main Floor Laundry: Yes
 Walk-in Pantry: No
 Office/Den: No

Plan #: 2011553

Exterior Walls: 2x6 x 8 Ft. (Main Floor)
 Foundation: 4'-6" 2x6 Pony Wall on 4' ICF Wall (Other Foundations Available)
 Special Ceilings: No
 Fireplace: No
 Deck(s): Rear (Covered)
 Veranda: Yes
 Attached Garage: No
 Finished Basement Plan: No

A Great Bi-Level Starter Home: The front of this home takes on a great look just by using wider corners, window and door trims, and the panel style columns under the extended roof over the front entry. A large front entry greets your guests. The openness of this plan will be very noticeable when you enter the living room area. The dining area is in the middle of the living room and kitchen. A pantry, phone desk, and lunch counter are in this U-shaped kitchen with access to the rear covered deck. It has two nice sized bedrooms with the master having a 3-piece ensuite. The basement is undeveloped except for the mechanical room. Large windows in the basement allow more natural lighting for future development. Overall, a very nice floor plan.

PROTECTED BY COPYRIGHT LAWS.
 PROPERTY OF ***E-DESIGNS PLANS INC.***

E-Designs Plans Inc.

A western Canadian company from Alberta that designs and ships home plans all across Canada, the US, and Overseas.

For more information about this plan contact the designer at: info@edesignsplans.ca.

Plan 2011553

www.edesignsplans.ca

[Call Us 1-855-675-1800](tel:1-855-675-1800)

Main Floor

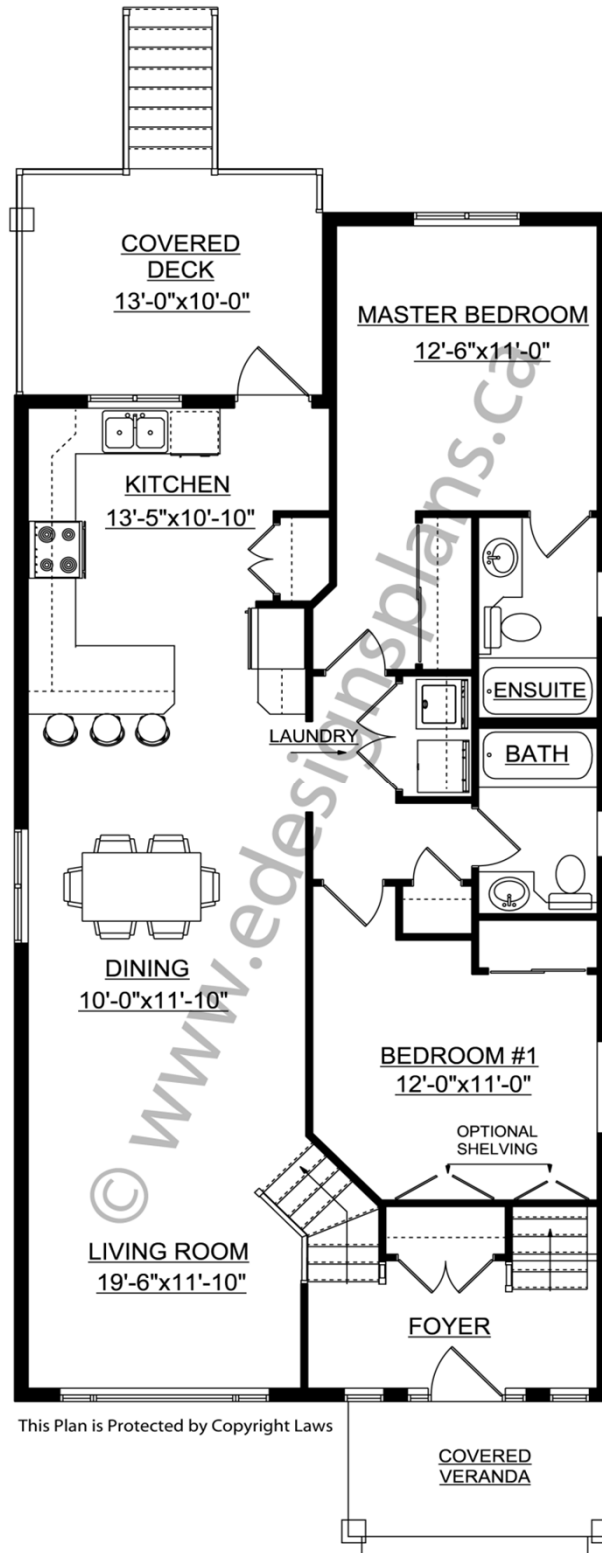

This Plan is Protected by Copyright Laws

PROTECTED BY COPYRIGHT LAWS.
PROPERTY OF **E-DESIGNS PLANS INC.**