

E-Designs Plans Inc.

A western Canadian company from Alberta that designs and ships home plans all across Canada, the US, and Overseas.

For more information about this plan contact the designer at: info@edesignsplans.ca.

Plan #: 2010513 Front Elevation

www.edesignsplans.ca

Call Us 1-855-675-1800



Side Elevation



Front to Back Duplex

1430 Sq. Ft. Total Living Area Per Unit

Width: 23'-0"
 Depth: 64'-0"
 Bedrooms: 3
 Bathrooms: 2
 Laundry: Lower Level
 Walk-in Pantry: No
 Office/Den: No

Plan #: 2010513

Exterior Walls: 2x6 x 8 Ft. (Main Floor)
 Foundation: 5' 2x6 Pony Wall on 4' Concrete (Other Foundations Available)
 Special Ceilings: None
 Fireplace: No
 Deck(s): No
 Veranda: No
 Attached Garage: No
 Finished Basement Plan: Yes

1430 Sq. Ft. Per Unit in this Front to Back Duplex. This narrow lot Duplex has been designed to be built cost effectively keeping with a basic, yet very functional design. The lowered front entry gives access to the lower level and upper level. The main floor has an open design. The large "U"-shaped kitchen with an extended lunch counter is open to the living room. The dining area is also open to the kitchen. The lower level has been designed with 9 ft. ceilings to accommodate larger windows in all the rooms. This level features three spacious bedrooms, a three piece bath, and a laundry room. There is a storage area under the stairway across from the mechanical room. This plan is perfect for a narrow or a corner lot.

PROTECTED BY COPYRIGHT LAWS.
 PROPERTY OF **E-DESIGNS PLANS INC.**

E-Designs Plans Inc.

A western Canadian company from Alberta that designs and ships home plans all across Canada, the US, and Overseas.

For more information about this plan contact the designer at: info@edesignsplans.ca.

Plan 2010513

www.edesignsplans.ca

Call Us 1-855-675-1800

Main Floor

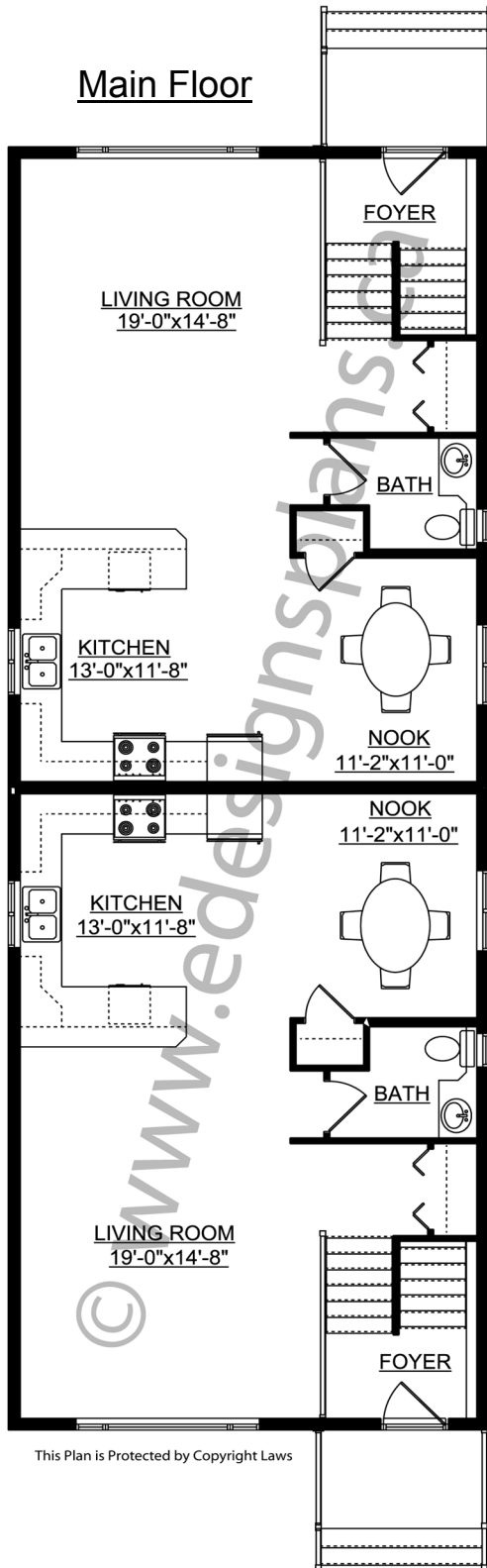

Lower Floor

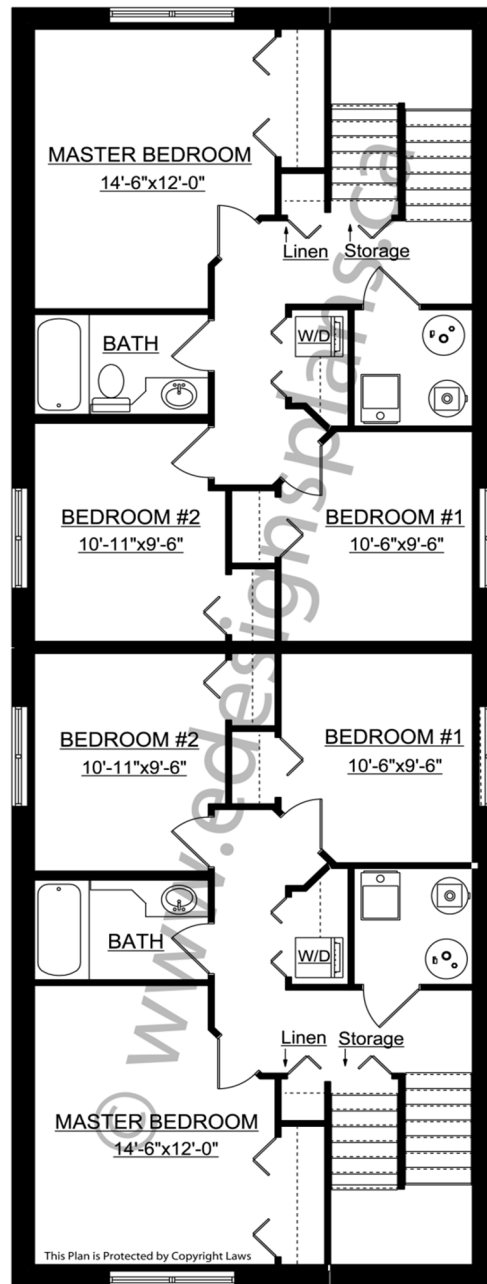

PROTECTED BY COPYRIGHT LAWS.
PROPERTY OF **E-DESIGNS PLANS INC.**