

E-Designs Plans Inc.

A western Canadian company from Alberta that designs and ships home plans all across Canada, the US, and Overseas.

For more information about this plan contact the designer at: info@edesignsplans.ca.

Plan #: 2012655 Front Elevation

www.edesignsplans.ca

Call Us 1-855-675-1800



Side Elevation



Narrow Front to Back Bi-Level Duplex

950 Sq. Ft. Main Floor

783 Sq. Ft. Lower Floor

1733 Sq. Ft. Total Living Area Per Unit

| | |
|---------------------|--------|
| Width: | 26'-0" |
| Depth: | 78'-0" |
| Bedrooms: | 3 |
| Bathrooms: | 2 |
| Main Floor Laundry: | Yes |
| Walk-in Pantry: | No |

Plan #: 2012655

| | |
|-------------------------|--|
| Exterior Walls: | 2x6 x 8 Ft. (Main Floor) |
| Foundation: | 5' 2x6 Pony Wall on 4' Concrete (Other Foundations Available) |
| Special Ceilings: | No |
| Separate Entrances: | Yes |
| Veranda: | Yes |
| Attached Garage: | No |
| Finished Basement Plan: | No |
| Storage: | Yes |

Narrow Bi-Level Duplex - More square footage for a smaller lot. This bi-level front-to-back duplex has a great curb appeal which would fit in nicely in any neighbourhood. From the covered split front entry, enter onto the upper level's open design. The uniquely designed kitchen is open to the dining and living rooms. You could add a vaulted ceiling in this area. There is a large storage room and a 3-piece bathroom next to the master bedroom. Here you have a walk-in closet and access to the main bathroom. There are two more nice sized bedrooms each with good sized closets in the lower level. The laundry area is combined with the 3-piece bathroom. There is a large rec room and more storage under the front landing. All the windows in the lower level are 40 inches high which is the same height of the bedroom windows on the upper floor. Overall, this is great design which should be very easy to keep rented.

PROTECTED BY COPYRIGHT LAWS.
PROPERTY OF **E-DESIGNS PLANS INC.**

E-Designs Plans Inc.

A western Canadian company from Alberta that designs and ships home plans all across Canada, the US, and Overseas.

For more information about this plan contact the designer at: info@edesignsplans.ca.

Plan 2012655

www.edesignsplans.ca

Call Us 1-855-675-1800

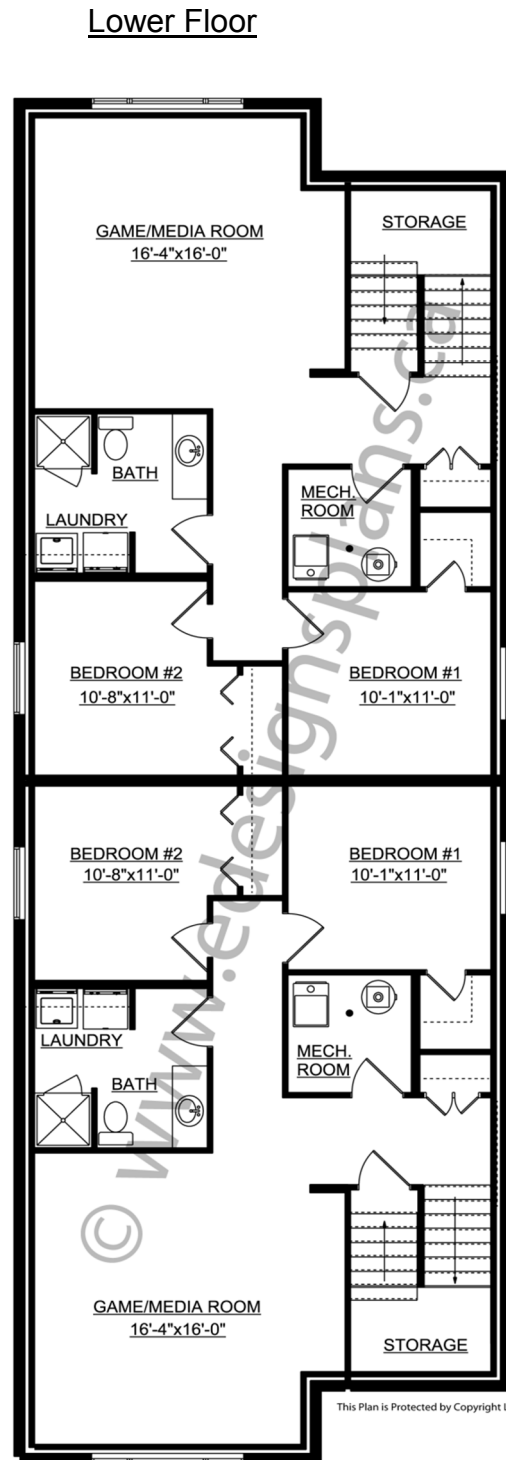
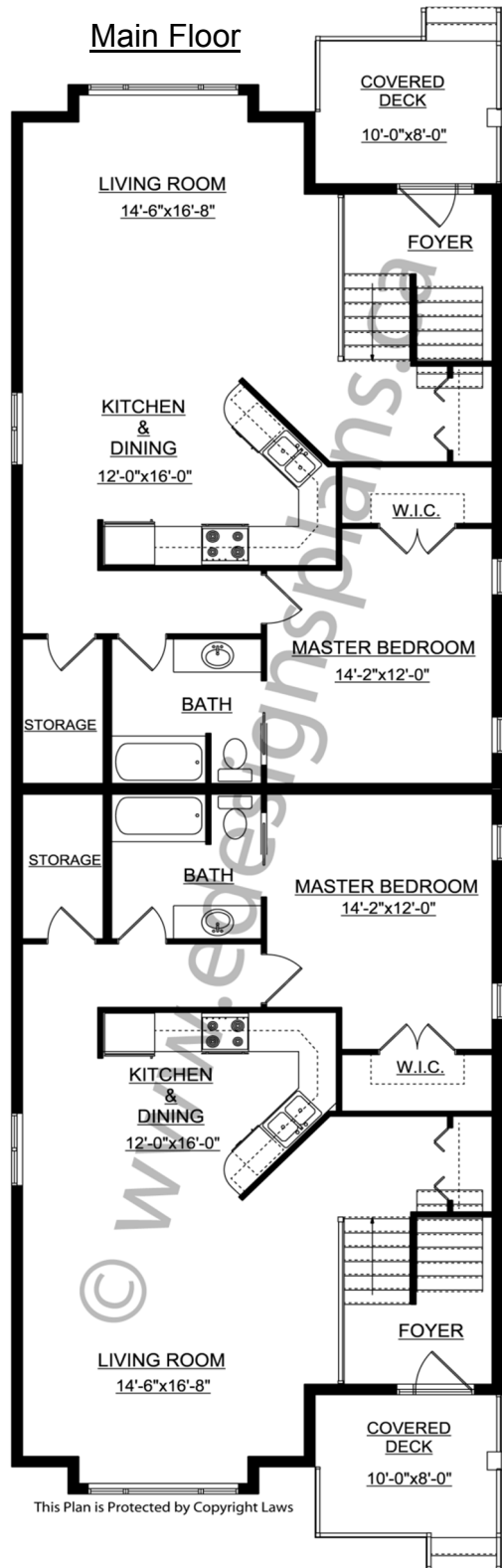

PROTECTED BY COPYRIGHT LAWS.
PROPERTY OF **E-DESIGNS PLANS INC.**