

E-Designs Plans Inc.

A western Canadian company from Alberta that designs and ships home plans all across Canada, the US, and Overseas.

For more information about this plan contact the designer at: info@edesignsplans.ca.

Plan #: 2014778 Front Elevation

www.edesignsplans.ca

Call Us 1-855-675-1800



Rear Elevation



Side by Side Duplex with 1-Car Garage

756 Sq. Ft. Main Floor

960 Sq. Ft. Second Floor

1716 Sq. Ft. Total Living Area

Width: 40'-0"

Depth: 52'-0" (+ entrances)

Bedrooms: 2

Bathrooms: 1

Main Floor Laundry: Yes

Walk-in Pantry: No

Office Area: Optional

Plan #: 2014778

Exterior Walls:

Foundation:

Special Ceilings:

Fireplace:

Deck(s):

Veranda:

Attached Garage:

Finished Basement Plan:

2x6 x 9 Ft. (Main Floor)

2x6 x 8 Ft. (Second Floor)

4' ICF (Insulated Concrete Form)
(Other Foundations Available)

None

No

Rear

No

Yes (1-Car with 9'x7' Doors)

No

Perfect Duplex for a Town Lot. This Duplex would fit nicely on a 50 foot lot. Each unit has its own garage. The main floor is undeveloped and could be used for office space, additional suites, or design it to suit your needs. This level has a front and rear covered entrance. The laundry and mechanical are located on this main level. The living quarters are up the stairs on the second floor. There is a coat closet at the top of the stairs. The dining room and living room are open to each other. The U-shaped kitchen has room for all appliances. There are two bedrooms, a 3-piece bath, and lots of closet space for the square footage. Live in one and rent the other out or live upstairs and design the main floors to be rented out. The options are endless with this floor plan.

PROTECTED BY COPYRIGHT LAWS.
PROPERTY OF **E-DESIGNS PLANS INC.**

E-Designs Plans Inc.

A western Canadian company from Alberta that designs and ships home plans all across Canada, the US, and Overseas.

For more information about this plan contact the designer at: info@edesignsplans.ca.

Plan 2014778

www.edesignsplans.ca

[Call Us 1-855-675-1800](tel:1-855-675-1800)

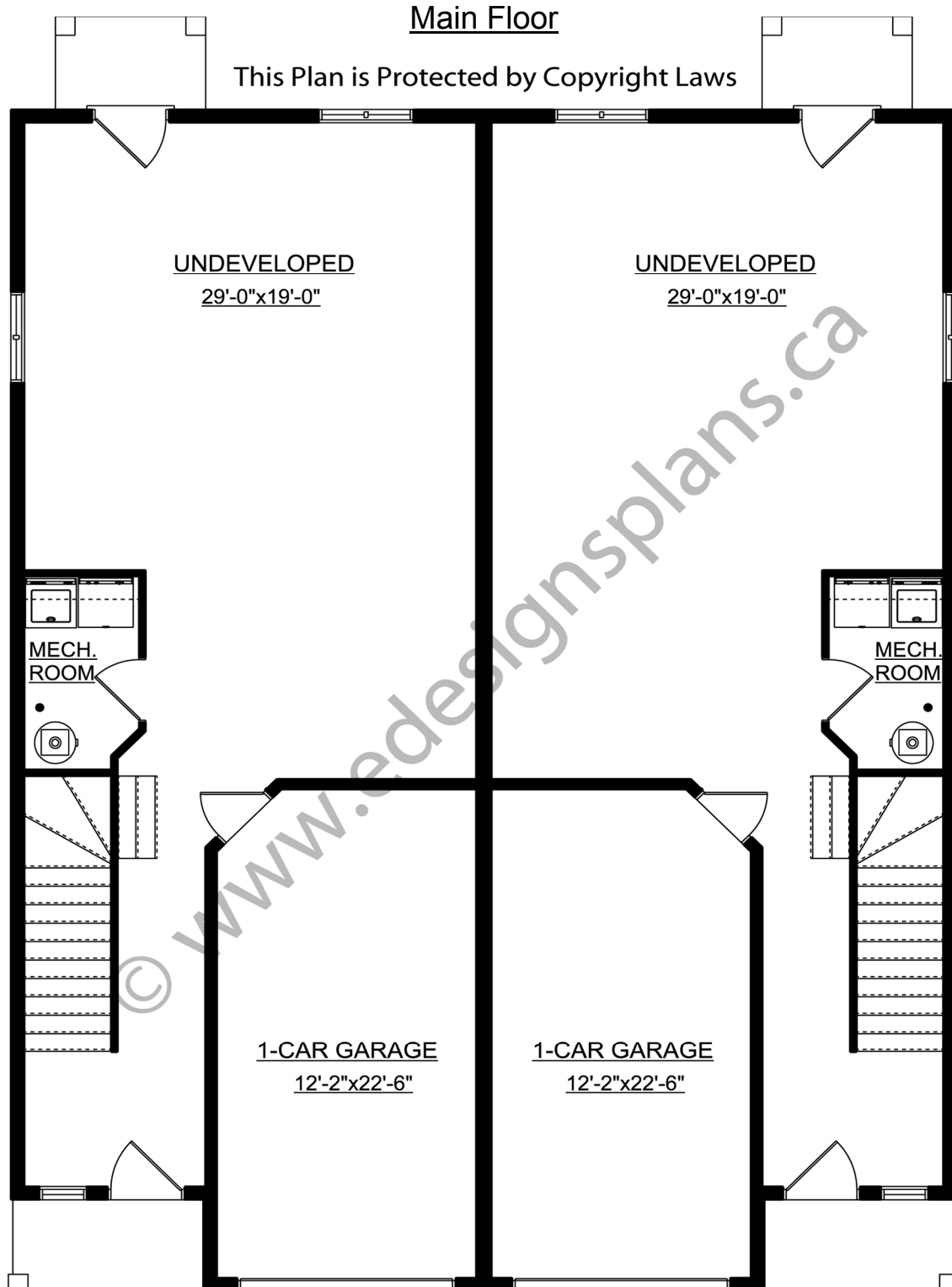

PROTECTED BY COPYRIGHT LAWS.
PROPERTY OF **E-DESIGNS PLANS INC.**

E-Designs Plans Inc.

A western Canadian company from Alberta that designs and ships home plans all across Canada, the US, and Overseas.

For more information about this plan contact the designer at: info@edesignsplans.ca.

Plan 2014778

www.edesignsplans.ca

[Call Us 1-855-675-1800](tel:1-855-675-1800)

Second Floor

This Plan is Protected by Copyright Laws

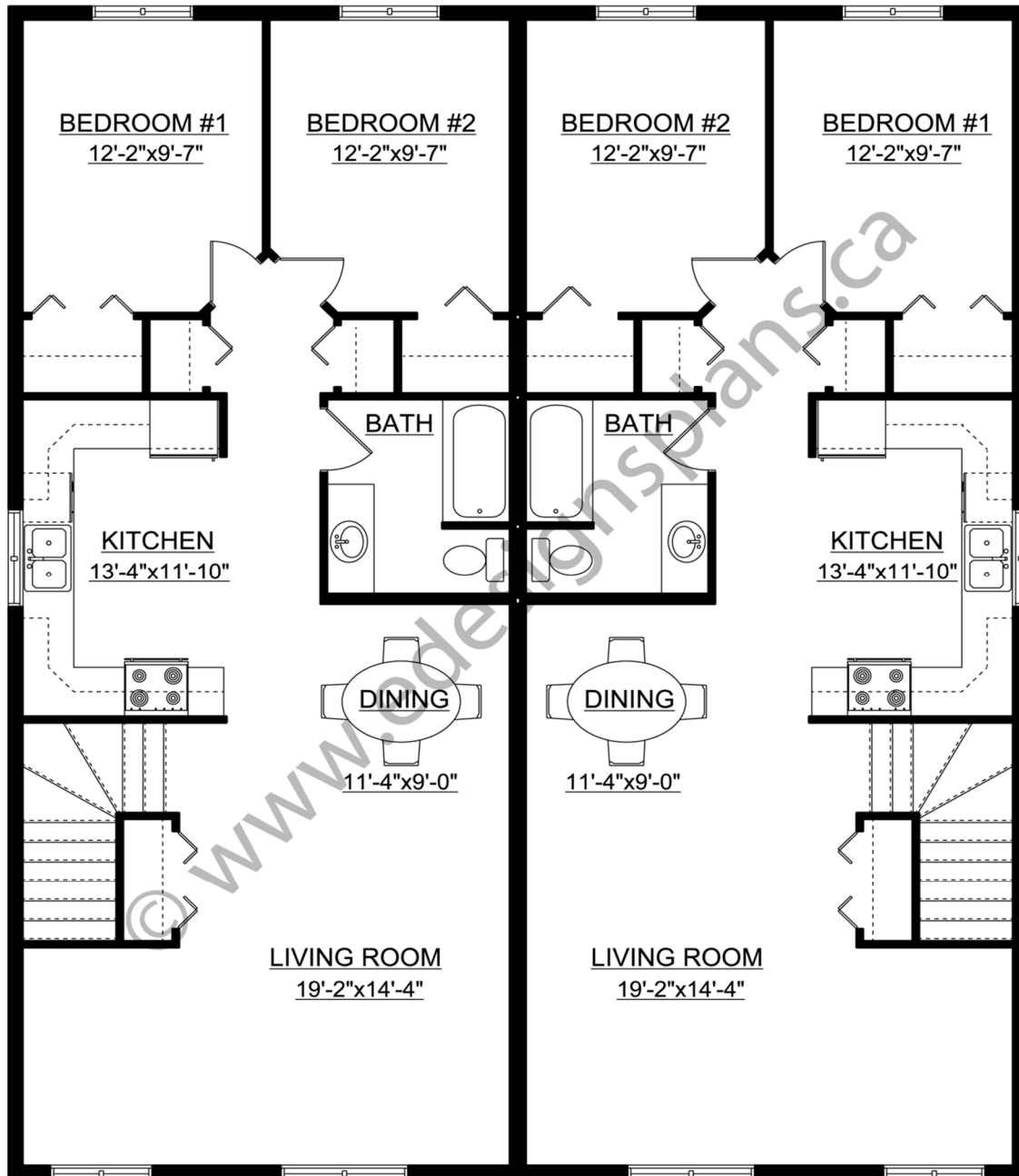

PROTECTED BY COPYRIGHT LAWS.
PROPERTY OF **E-DESIGNS PLANS INC.**