

E-Designs Plans Inc.

A western Canadian company from Alberta that designs and ships home plans all across Canada, the US, and Overseas.

For more information about this plan contact the designer at: info@edesignsplans.ca.

Plan #: 2020293 Front Elevation

www.edesignsplans.ca

Call Us 1-855-675-1800



Rear Elevation



Duplex Plan

1050 Sq. Ft. Main Floor per Side

Width: 40'-0"
Depth: 52'-6"
Bedrooms: 3
Bathrooms: 2
Main Floor Laundry: Yes
Walk-in Pantry: No
Office/Den/Flex Room: No

Plan #: 2020293

Exterior Walls: 2x6 x 8 Ft. (Main Floor)
Foundation: Slab on 4' Concrete Wall (Other Foundations Available)
Special Ceilings: Vaulted Towards Party Wall
Fireplace: No
Deck(s): No
Veranda: No
Attached Garage: No
Finished Basement Plan: No

Duplex Plan. The front of this design has a large picture window right beside the front entry for lots of natural lighting and a great view. The kitchen, dining and living room are open concept with the ceilings sloped towards the party wall in the centre. There is also a french door out from the dining room for a possible future deck if desired. A 3-bedroom plan with the master suite having its own walk-in closet and ensuite. Laundry and mechanical are combined and just down the hall from all three bedrooms. This would be an easy design to build with fairly straight alignment and a slab on grade foundation.

PROTECTED BY COPYRIGHT LAWS.
PROPERTY OF **E-DESIGNS PLANS INC.**

E-Designs Plans Inc.

A western Canadian company from Alberta that designs and ships home plans all across Canada, the US, and Overseas.

For more information about this plan contact the designer at: info@edesignsplans.ca.

Plan 2020293

www.edesignsplans.ca

[Call Us 1-855-675-1800](tel:1-855-675-1800)

Main Floor

This Plan is Protected by Copyright Laws

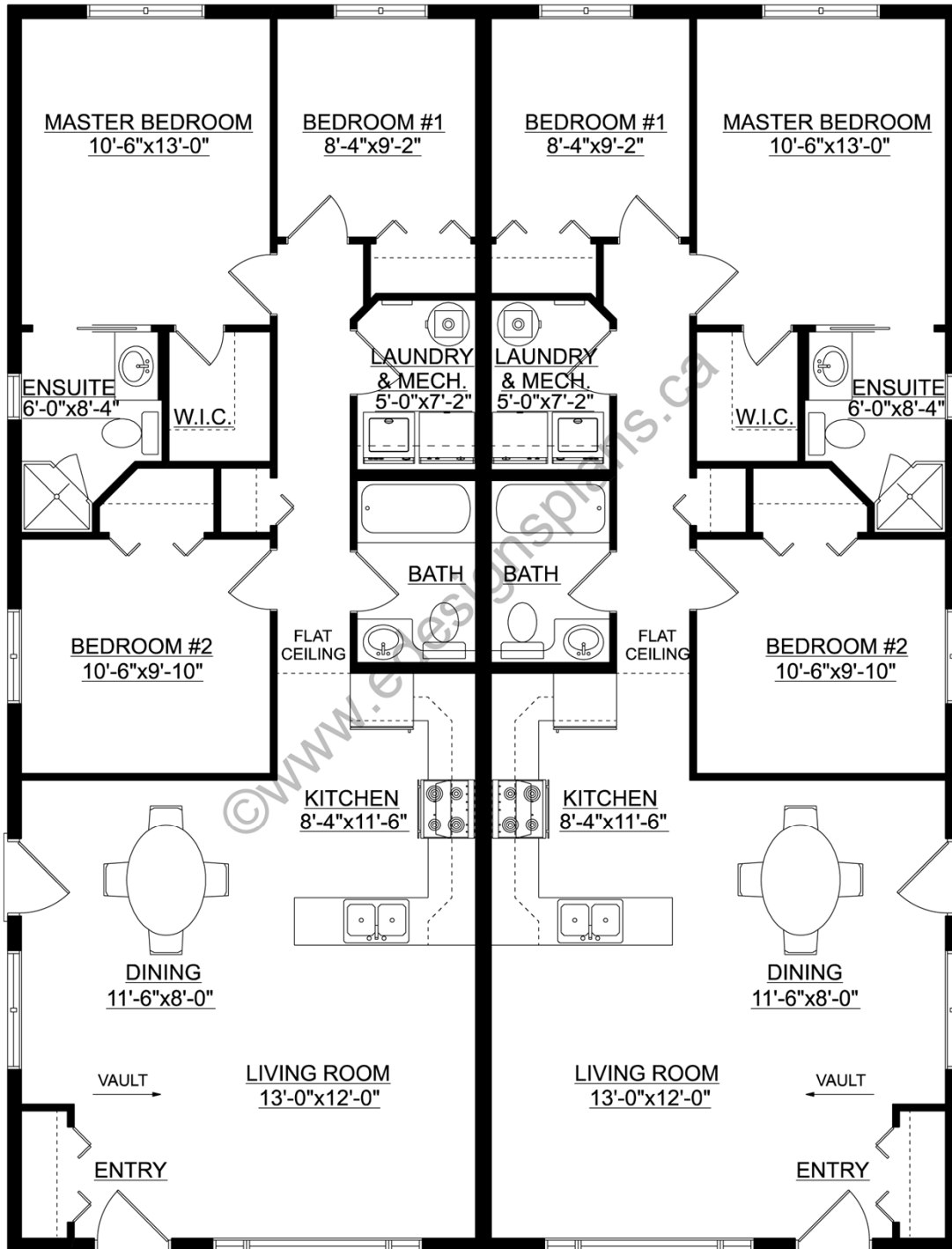

PROTECTED BY COPYRIGHT LAWS.
PROPERTY OF **E-DESIGNS PLANS INC.**